



SECRET JARDIN

---



## ASSEMBLY INSTRUCTIONS

# EXPERT

■ INT120 .....	p 2
■ INT240 .....	p 5
■ INT480 .....	p 8
■ INT150 .....	p 14
■ INT300 .....	p 17
■ INT600 .....	p 20
■ TENTS SPECIFICATIONS .....	p 26



- WebIT**
- 18 x T30-C
  - 16 x T30-B
- Space Booster**
- 15 x T30-G
- 

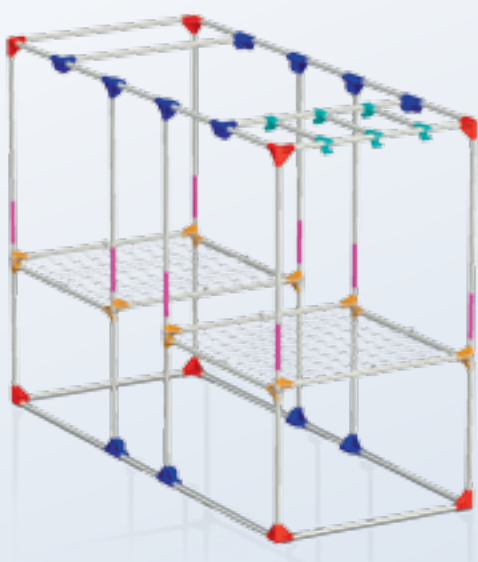
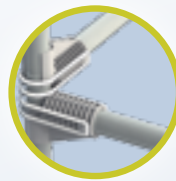
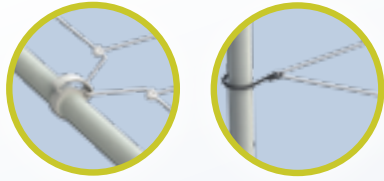

- 8 x C30-Y
  - 12 x C30-T
  - 6 x C30-H
  - 16 x C30-SB
  - 16 x C30-SBR
  - 8 x C30-L
  - 2 x WebIT120
- 

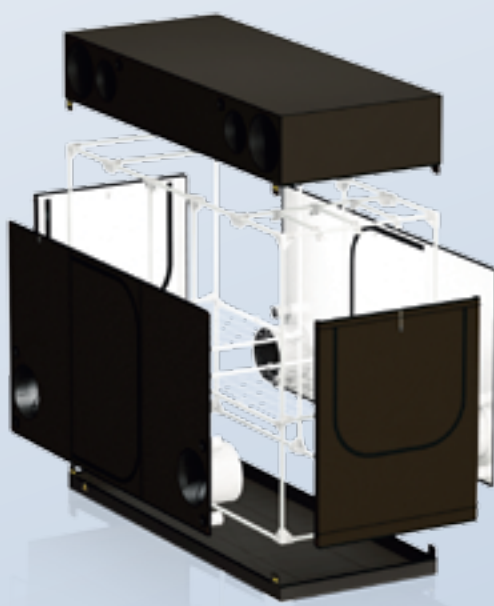

- HookIT**
- StrapIT**
- CableIT**
- 

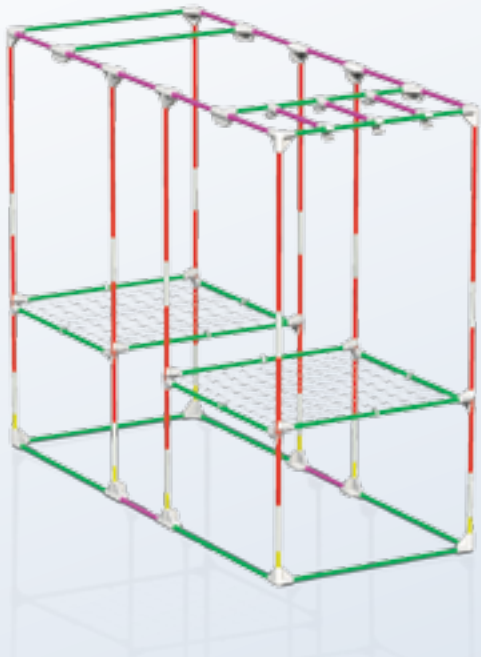

WebIT

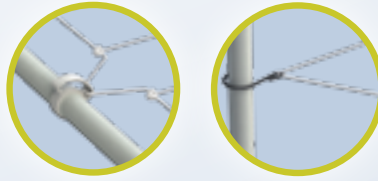

18 x T30-C

16 x T30-B

Space Booster

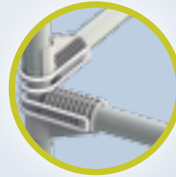

15 x T30-G

8 x T30-D

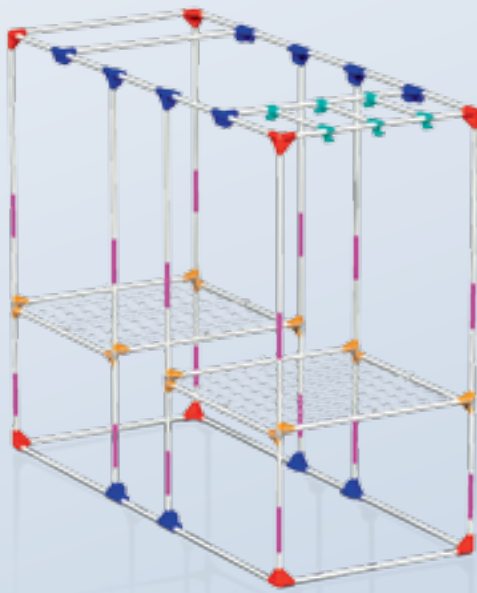

8 x C30-Y

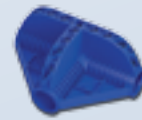

12 x C30-T



6 x C30-H

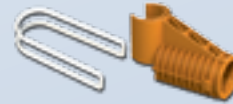

16 x C30-SB  
16 x C30-SBR



16 x C30-L

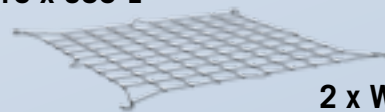

2 x WebiT120

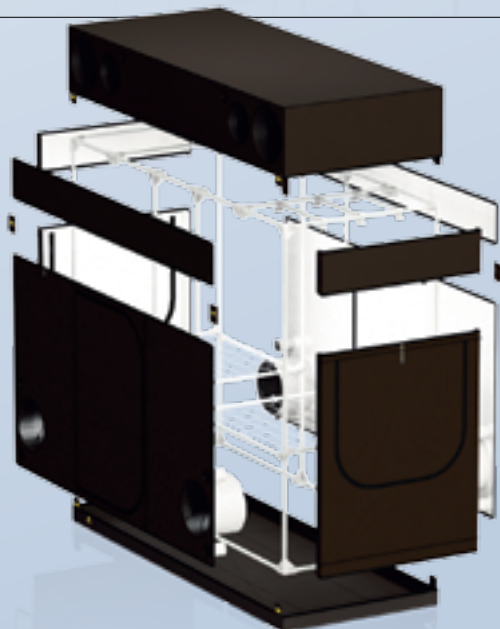

HookIT



StrapIT



CableIT

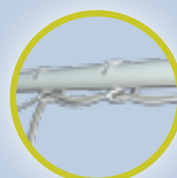

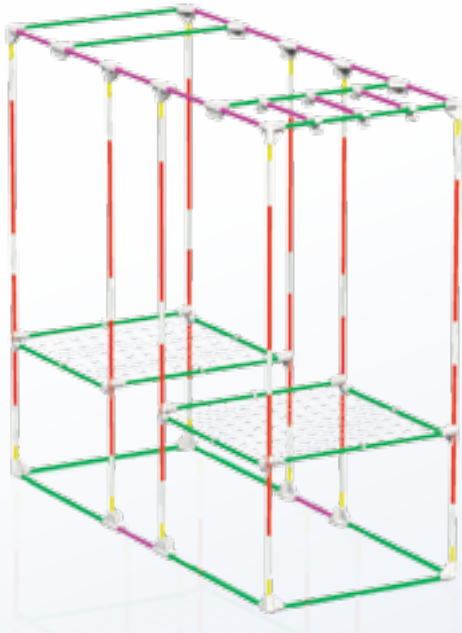

**WebIT**

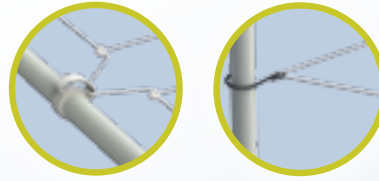

18 x T30-C

16 x T30-B

**Space Booster**

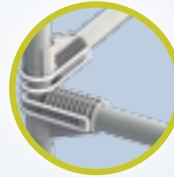

15 x T30-G

16 x T30-D

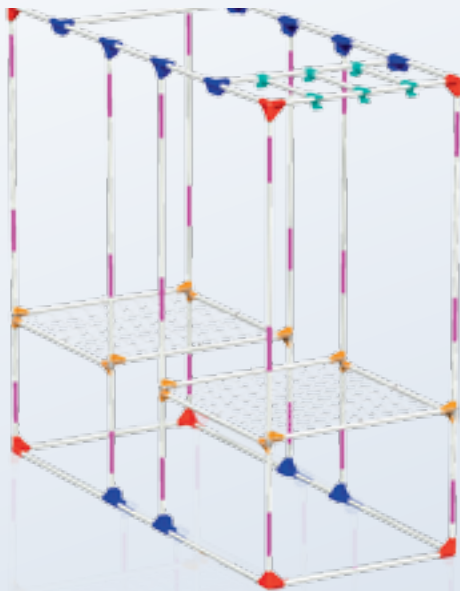

8 x C30-Y

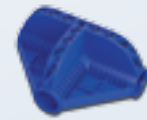

12 x C30-T



6 x C30-H

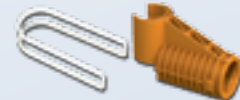

16 x C30-SB

16 x C30-SBR



24 x C30-L

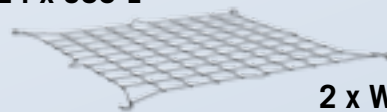

2 x WebiT120

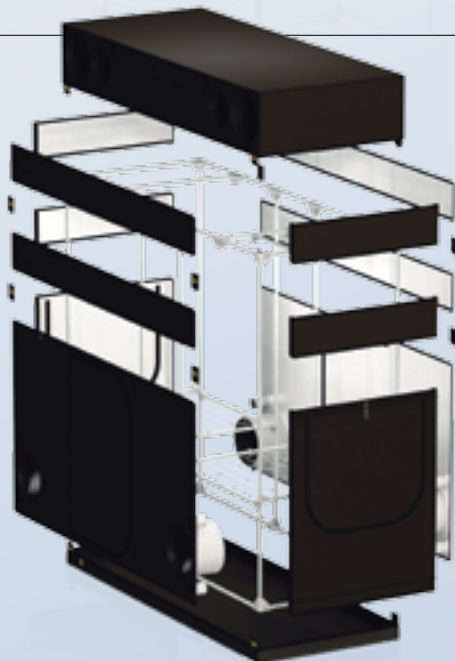

**HookIT**



**StrapIT**



**CableIT**

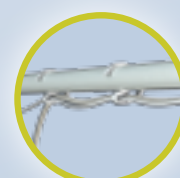

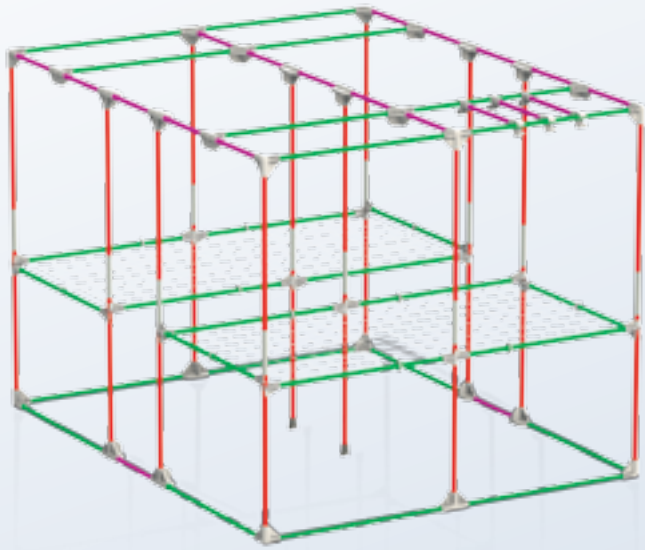

**WebIT**

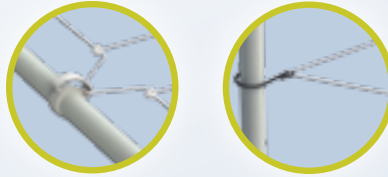

**Space Booster**

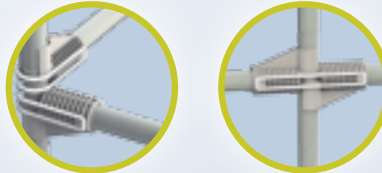

**Caoutchouc Feet**



28 x T30-C

24 x T30-B

20 x T30-G

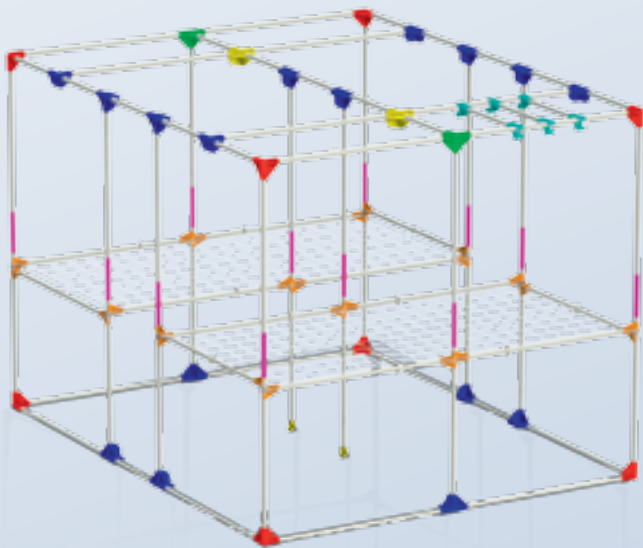

8 x C30-Y



2 x C30-K



16 x C30-T

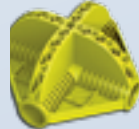

2 x C30-X



6 x C30-H



2 x C30-RF



12 x C30-L



24 x C30-SB



24 x C30-SBR

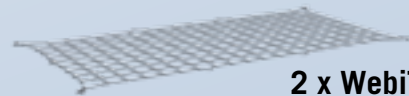

2 x WebiT240w

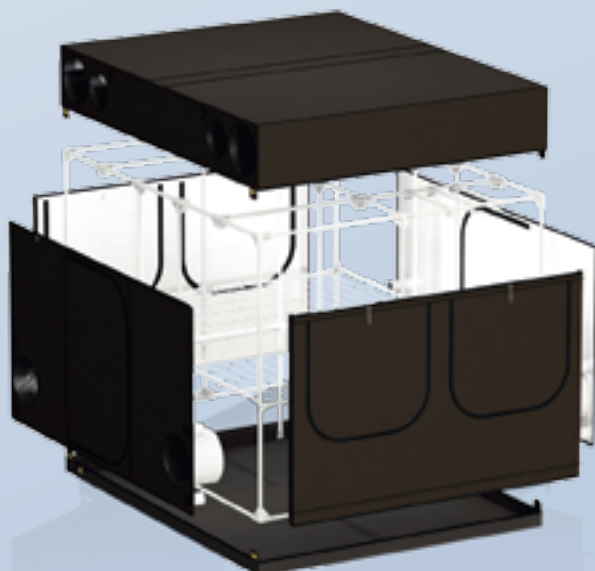

**HookIT**



**StrapIT**



**CableIT**

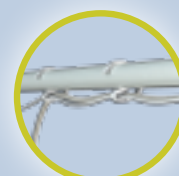

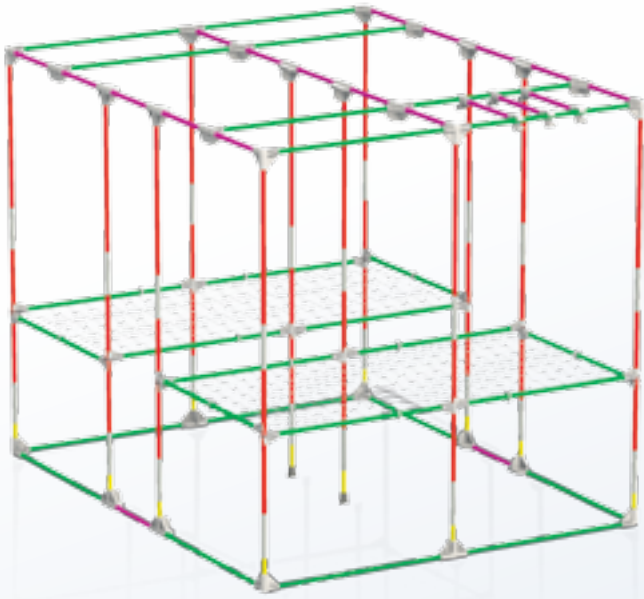

**WebIT**

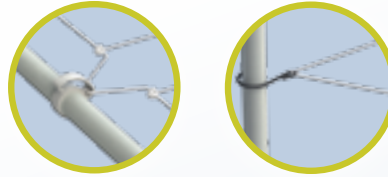

**Space Booster**

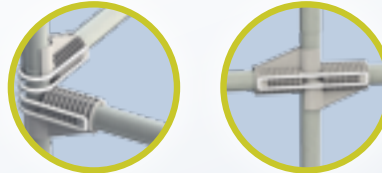

**Caoutchouc Feet**



28 x T30-C

24 x T30-B

20 x T30-G

12 x T30-D

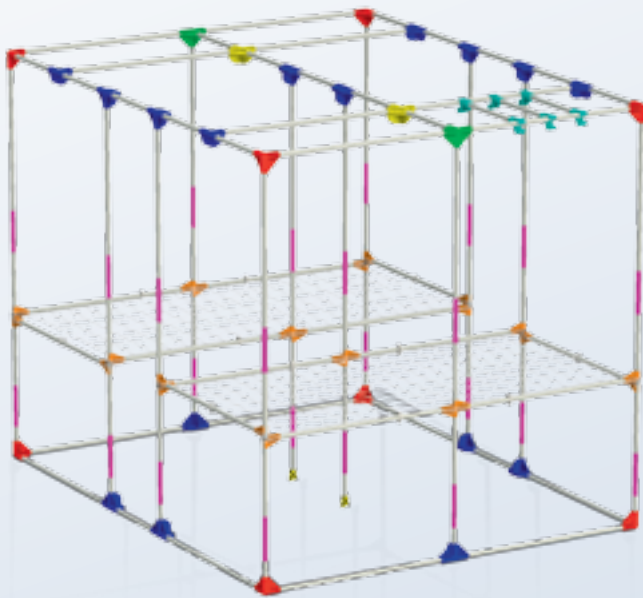

8 x C30-Y



2 x C30-K

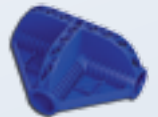

16 x C30-T

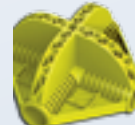

2 x C30-X



6 x C30-H



2 x C30-RF



24 x C30-L



24 x C30-SB



24 x C30-SBR

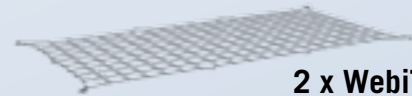

2 x WebiT240w

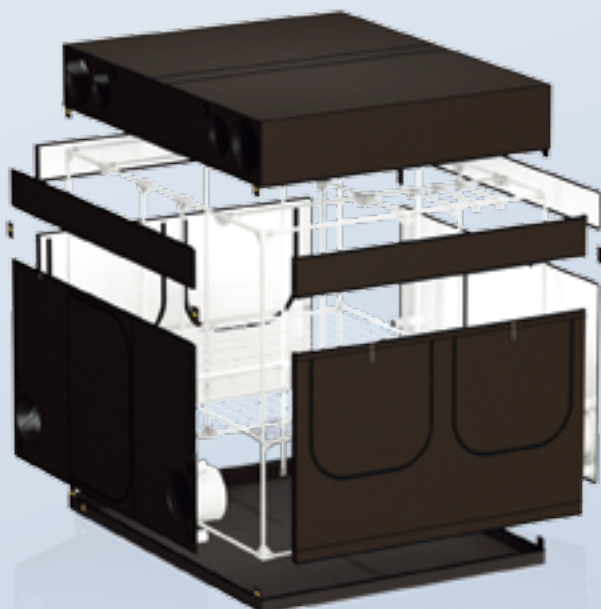

**HookIT**



**StrapIT**



**CableIT**

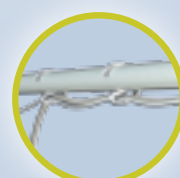



WebIT

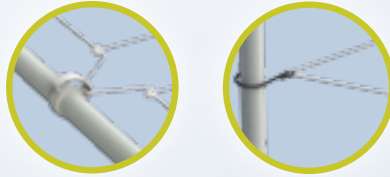

Space Booster

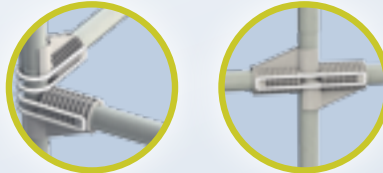

Caoutchouc Feet



28 x T30-C

24 x T30-B

20 x T30-G

24 x T30-D

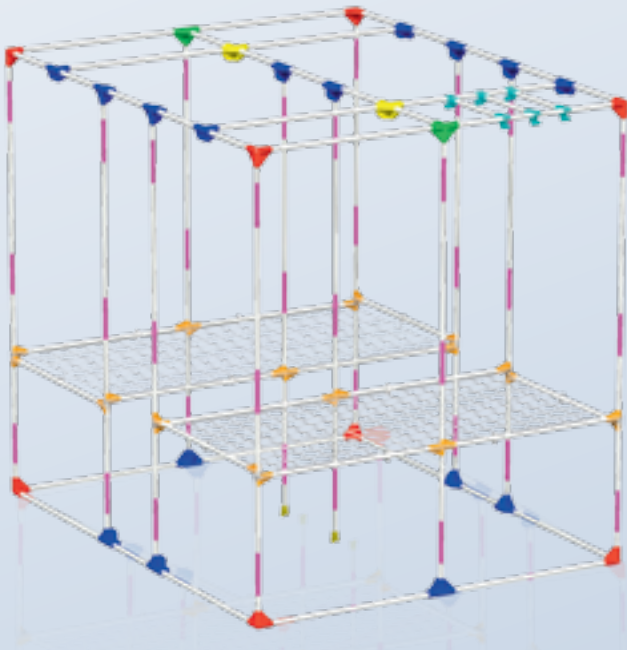
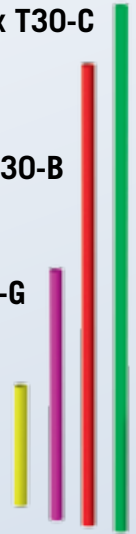

8 x C30-Y

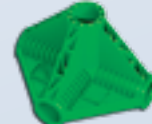

2 x C30-K

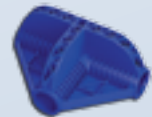

16 x C30-T



2 x C30-X



6 x C30-H



2 x C30-RF



36 x C30-L



24 x C30-SB  
24 x C30-SBR

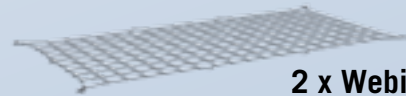

2 x WebiT240w

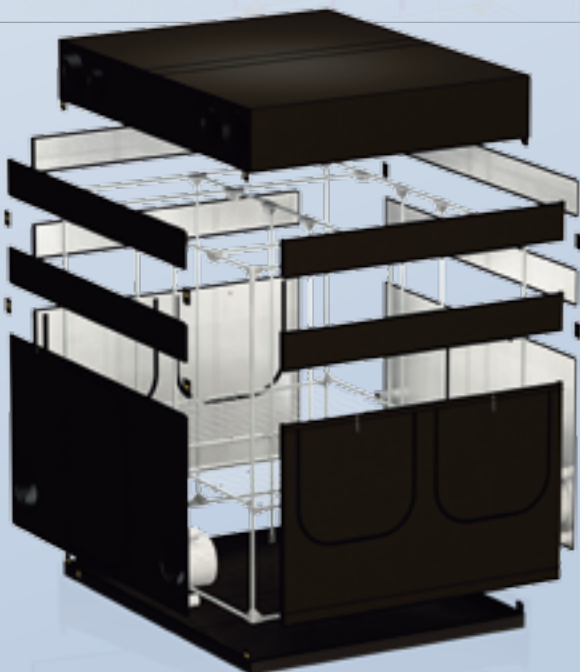

StrapIT



CableIT

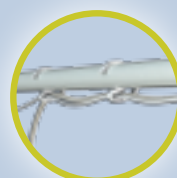

HookIT



StrapIT

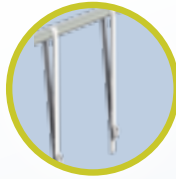

CableIT

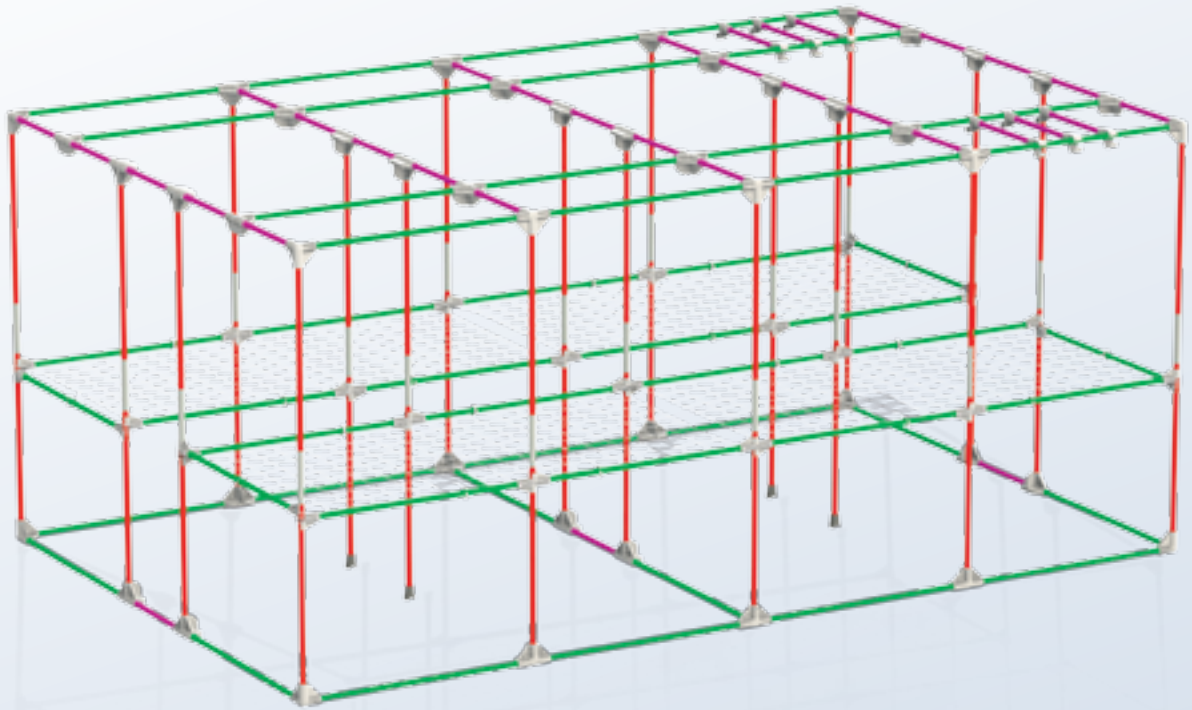
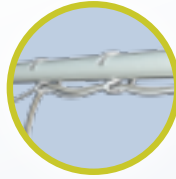

WebIT

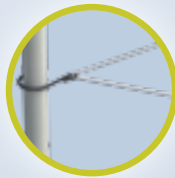
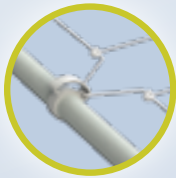

Space Booster

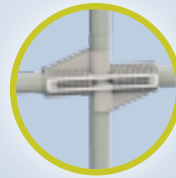
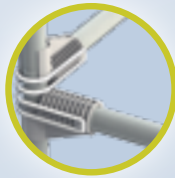

Caoutchouc Feet



50 x T30-C







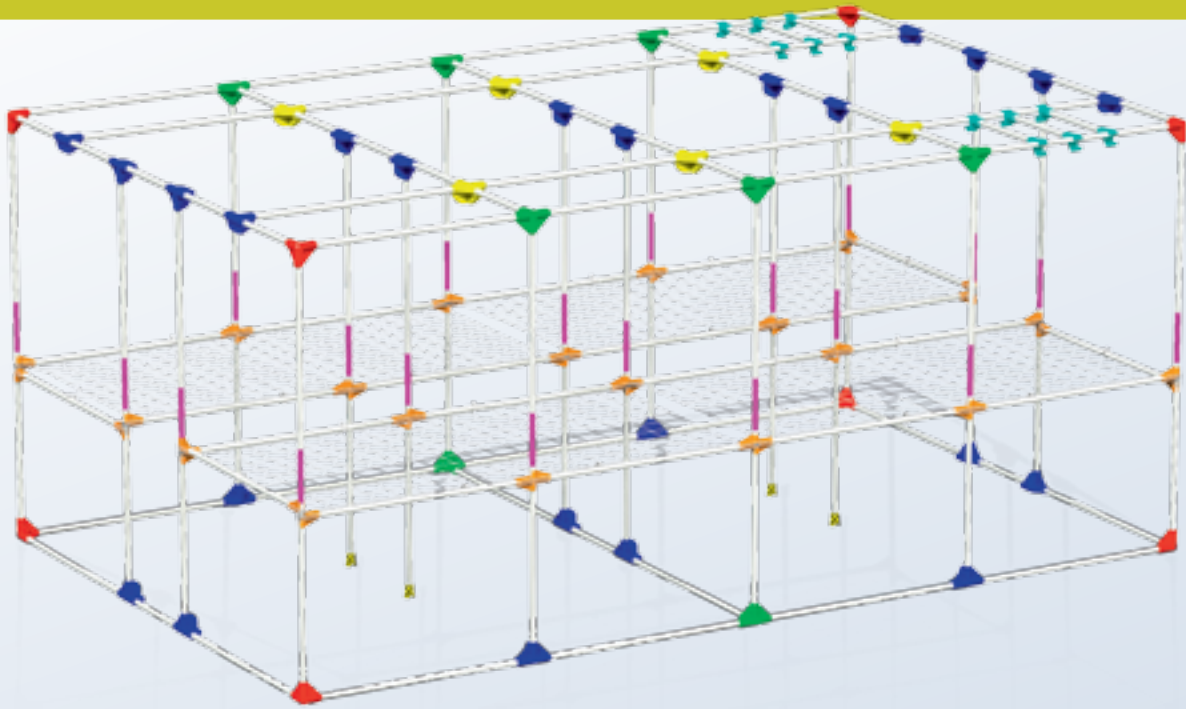

40 x T30-B

34 x T30-G





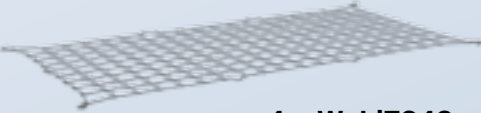

-   
**8 x C30-Y**
-   
**8 x C30-K**
-   
**24 x C30-T**
-   
**6 x C30-X**
-   
**12 x C30-H**
-   
**4 x C30-RF**
-   
**40 x C30-SB**  
**40 x C30-SBR**
-   
**4 x WebiT240w**
-   
**20 x C30-L**

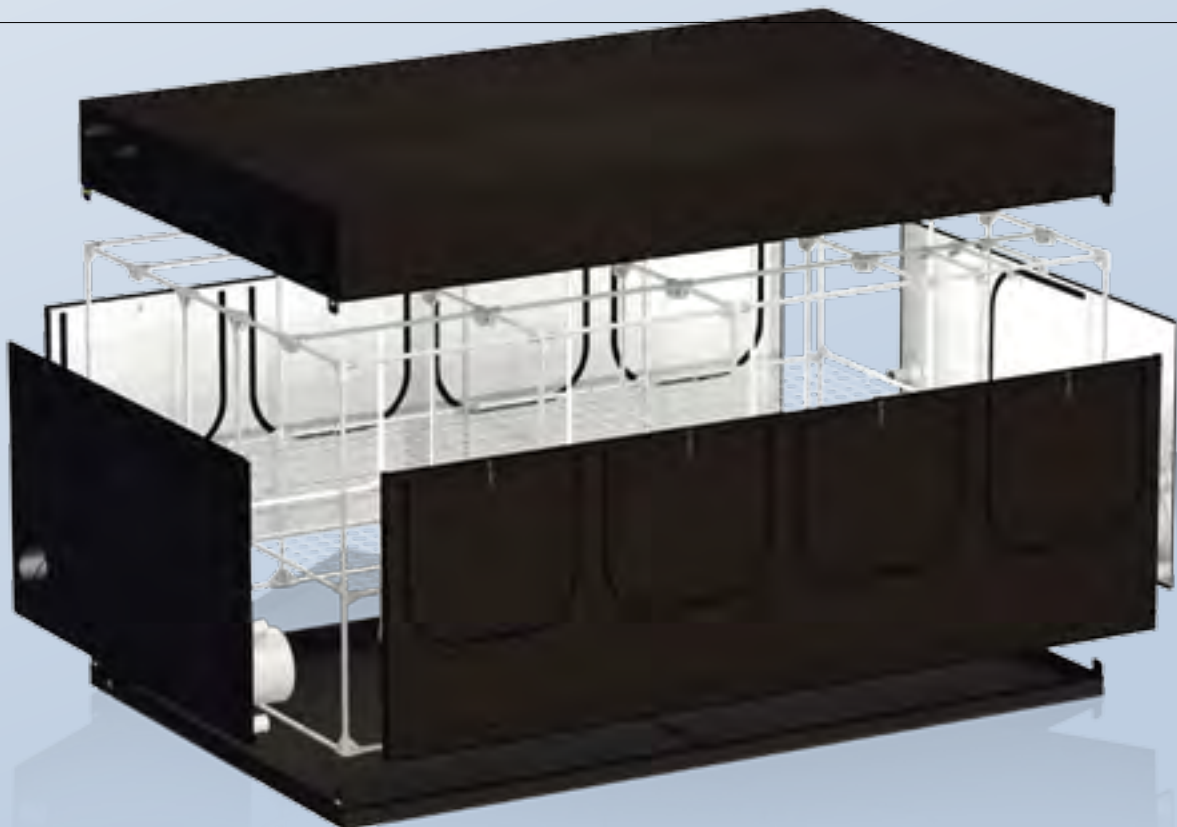

HookIT

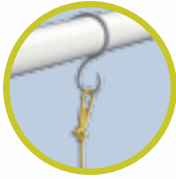

StrapIT

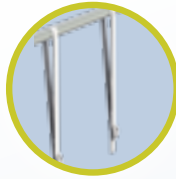

CableIT

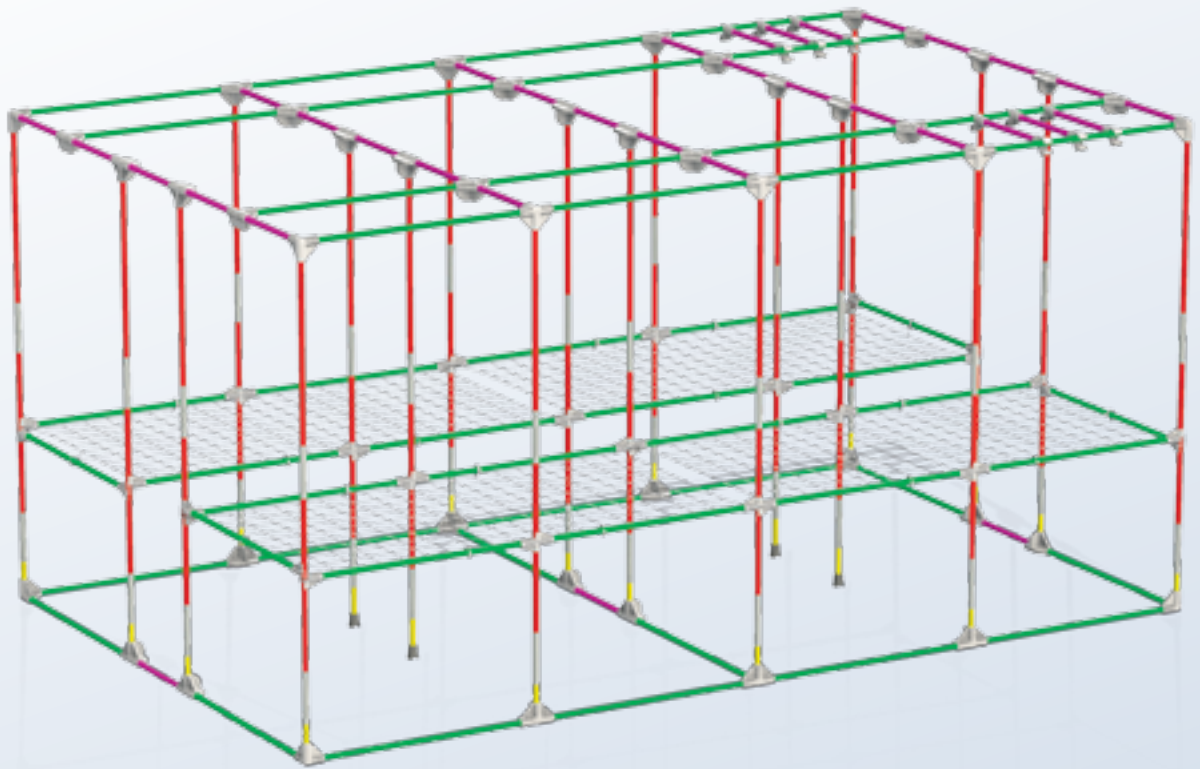
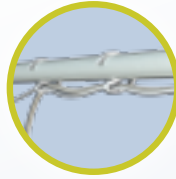

WebIT

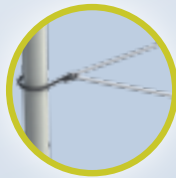

Space Booster

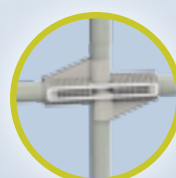

Caoutchouc Feet



50 x T30-C

40 x T30-B

34 x T30-G

20 x T30-D



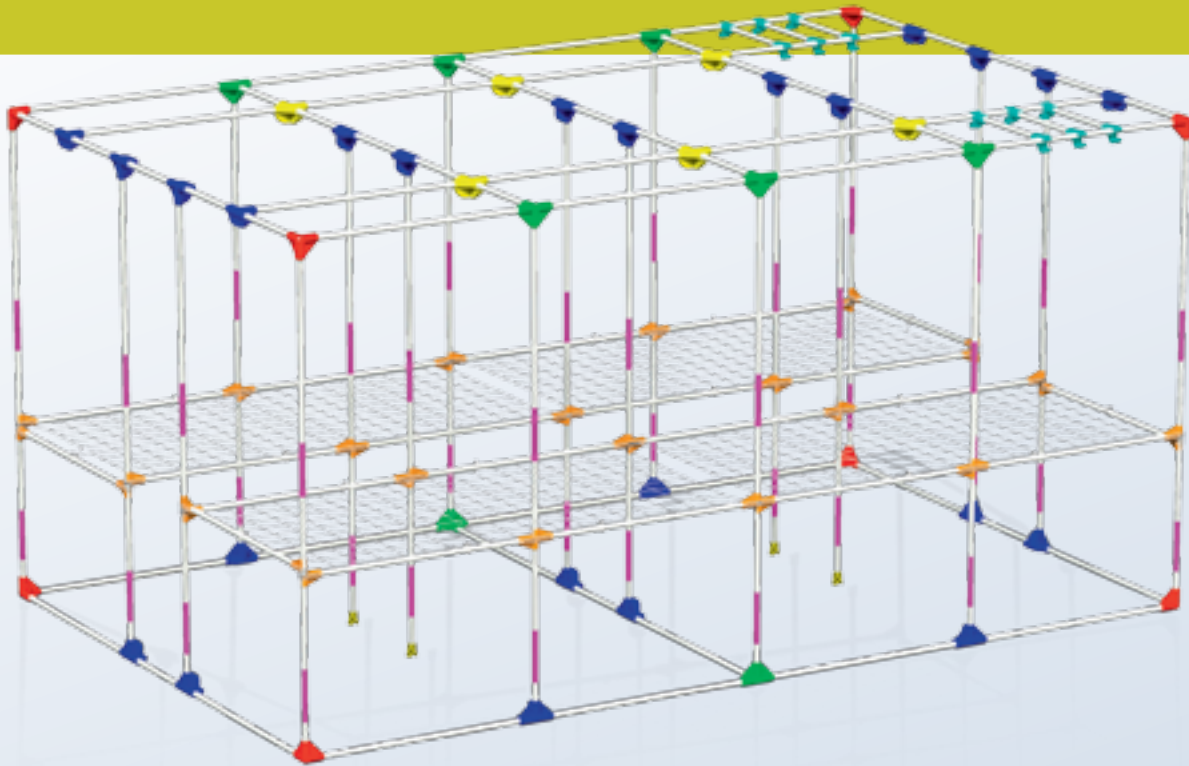

8 x C30-Y



8 x C30-T



24 x C30-T



6 x C30-X



12 x C30-H



4 x C30-RF

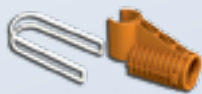

40 x C30-SB  
40 x CR30-SBR

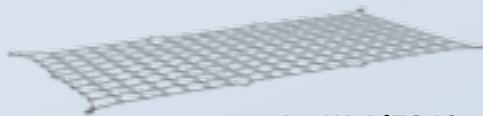

4 x WebiT240w



40 x C30-L

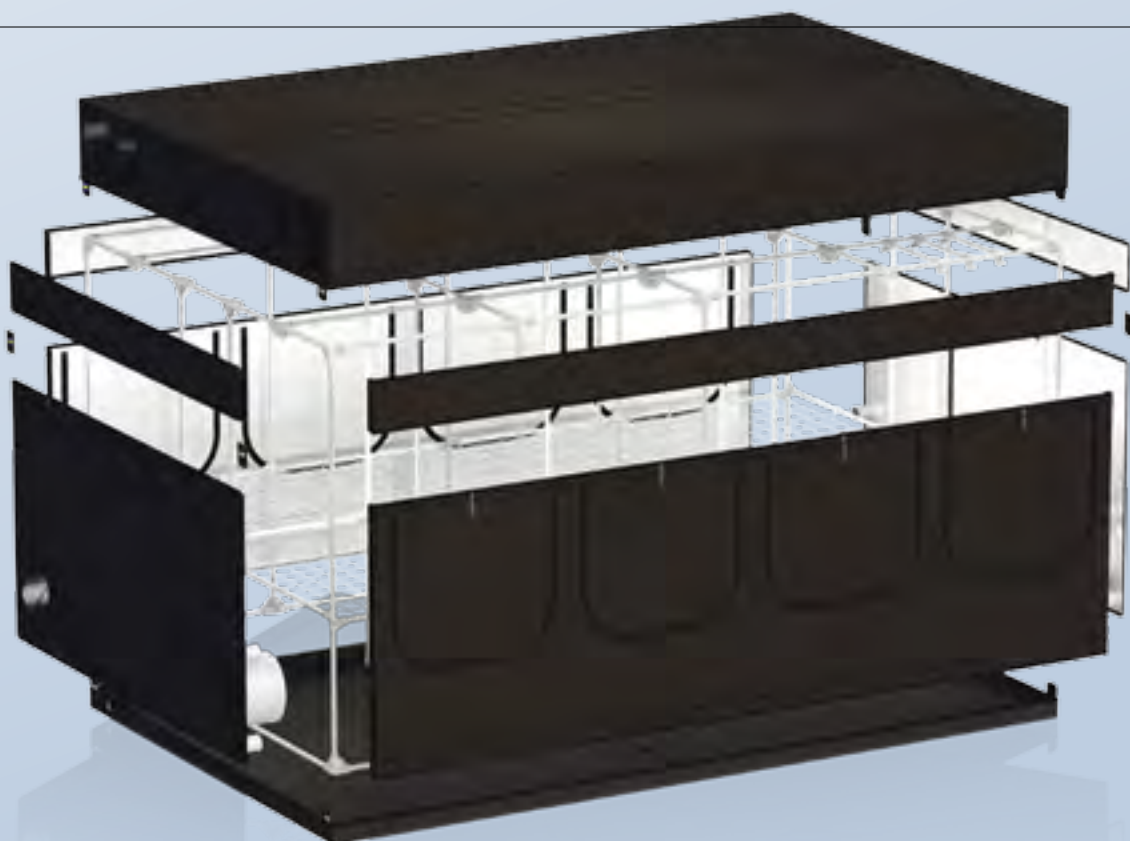

HookIT

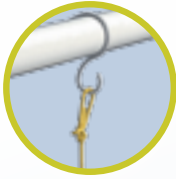

StrapIT

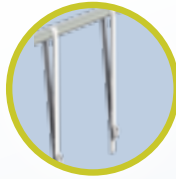

CableIT

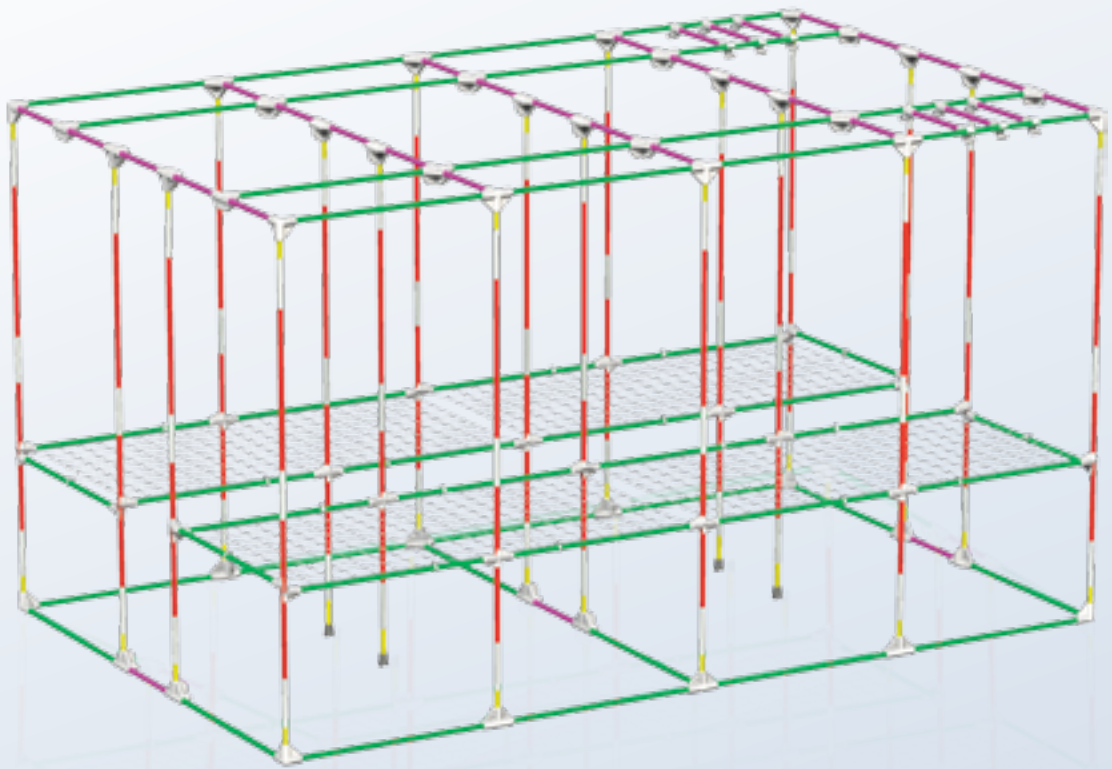
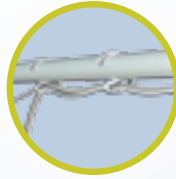

WebIT

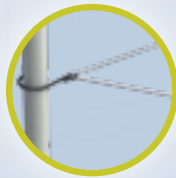

Space Booster

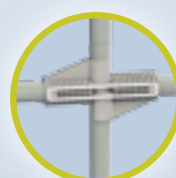

Caoutchouc Feet



50 x T30-C

40 x T30-B

34 x T30-G

40 x T30-D



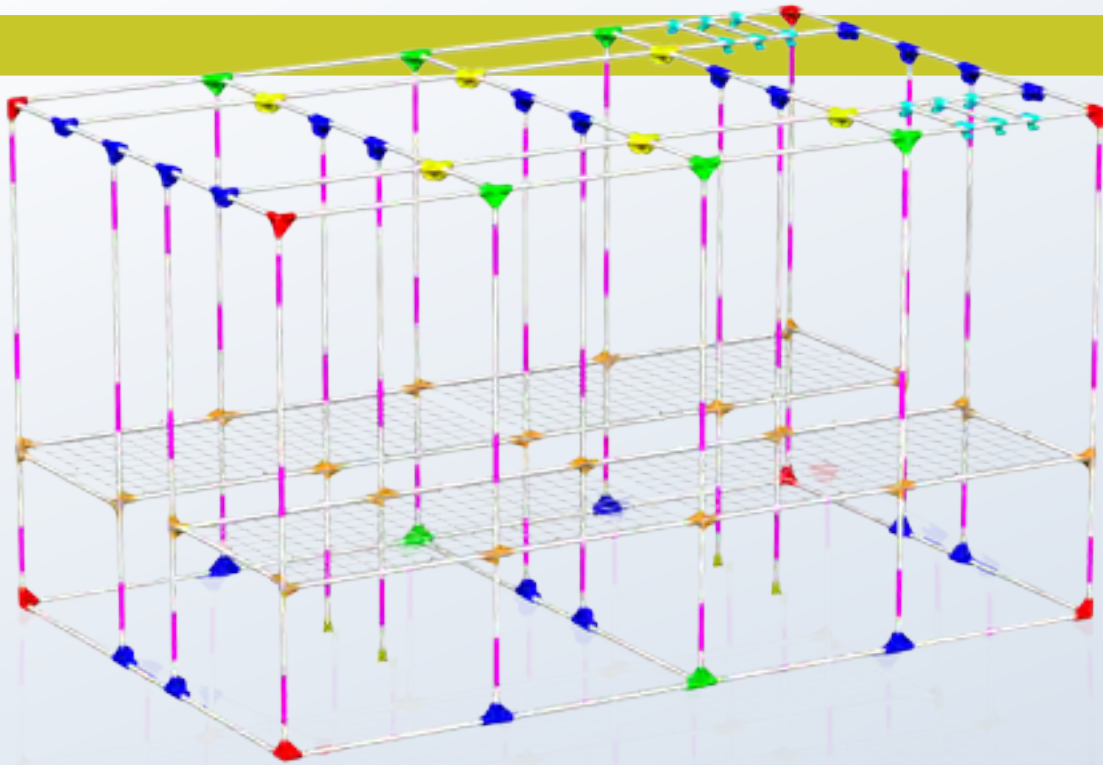

8 x C30-Y



8 x C30-T



24 x C30-T



6 x C30-X



12 x C30-H



4 x C30-RF

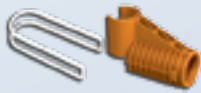

40 x C30-SB  
40 x CR30-SBR

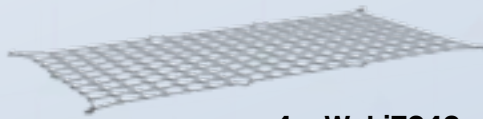

4 x WebiT240w



60 x C30-L

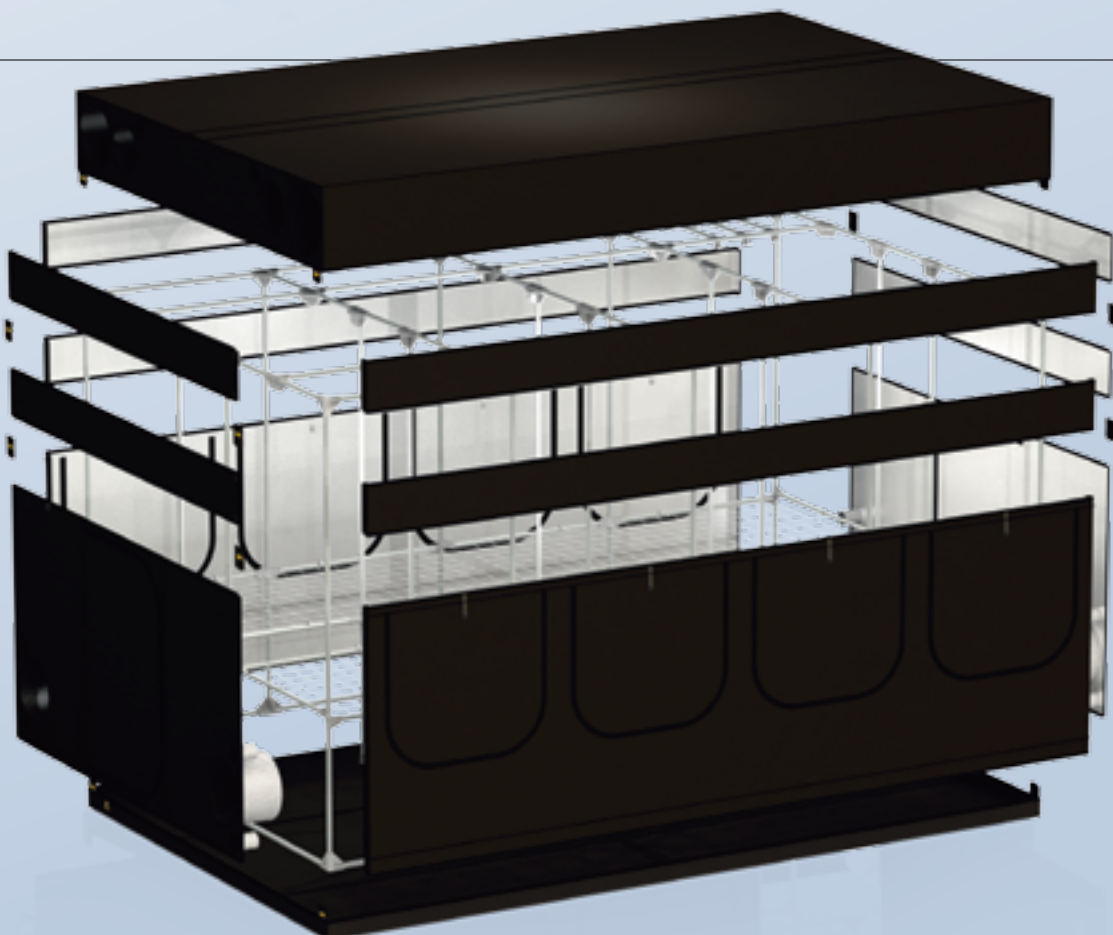

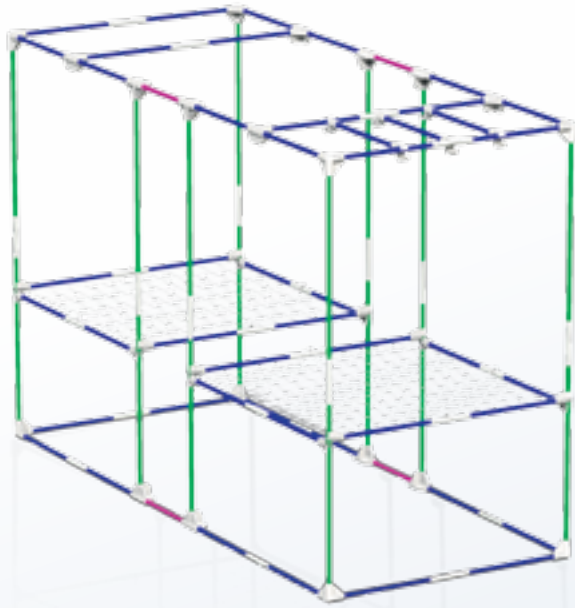

WebIT

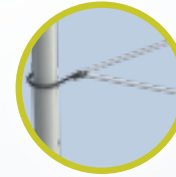
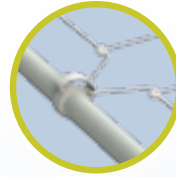

16 x T30-C

Space Booster

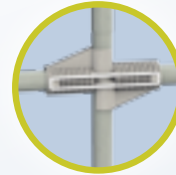
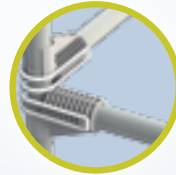

47 x T30-F

Caoutchouc Feet



4 x T30-G

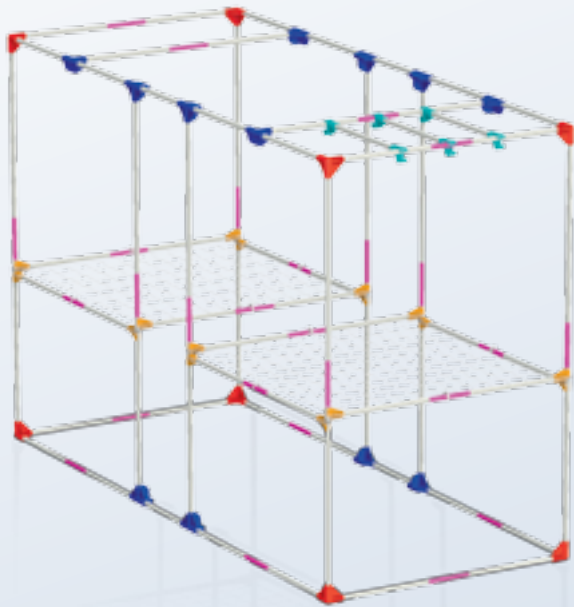

8 x C30-Y



12 x C30-T



6 x C30-H



26 x C30-L

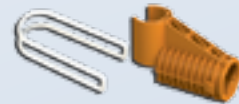

16 x C30-SBR

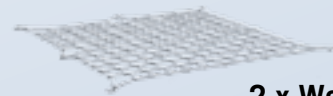

2 x WebiT150

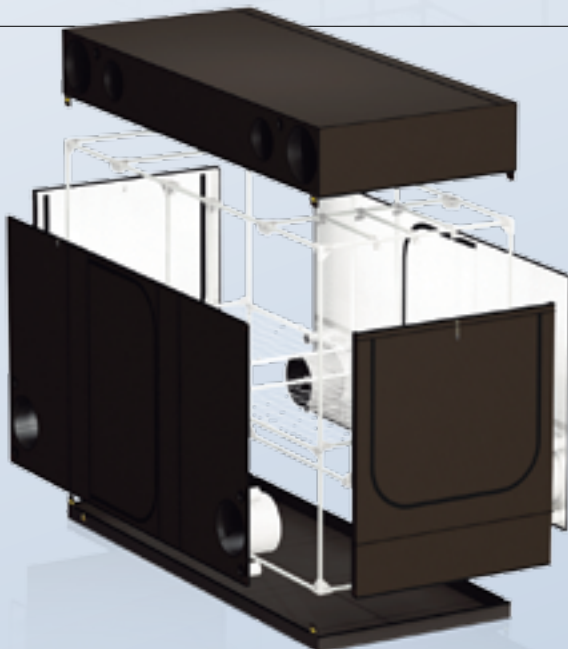

HookIT



StrapIT



CableIT

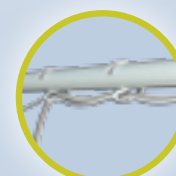

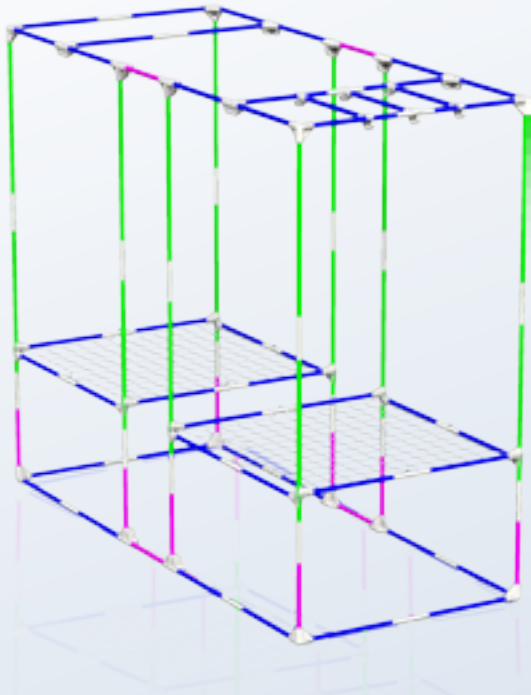

WebIT

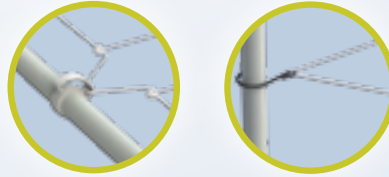

16 x T30-C

Space Booster

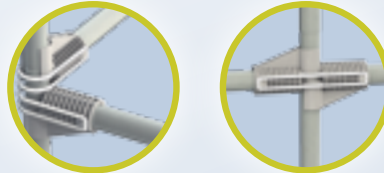

47 x T30-F

Caoutchouc Feet



12 x T30-G



8 x C30-Y



12 x C30-T



6 x C30-H



34 x C30-L

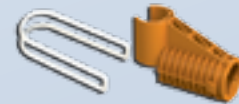

16 x C30-SBR



2 x WebIT150

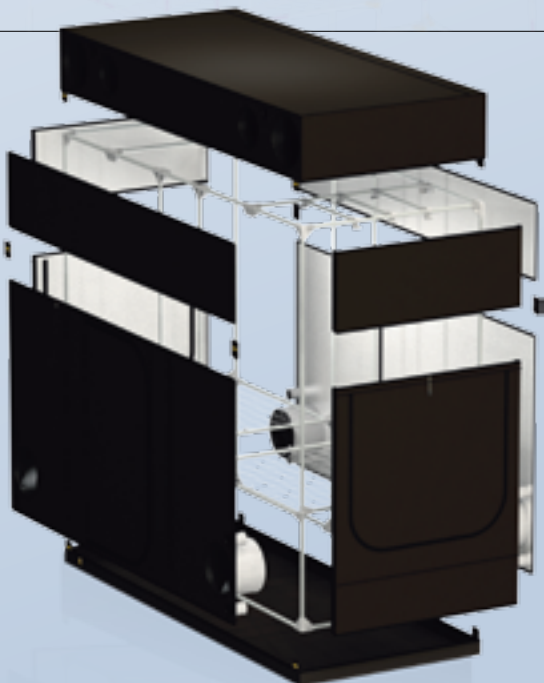

HookIT



StrapIT



CableIT

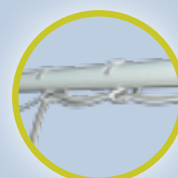

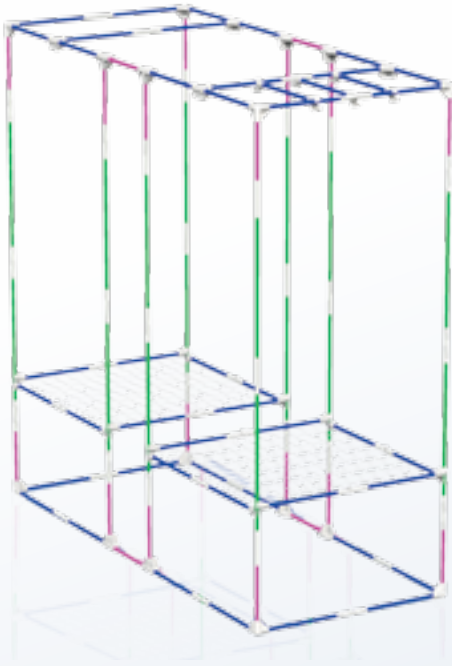

WebIT

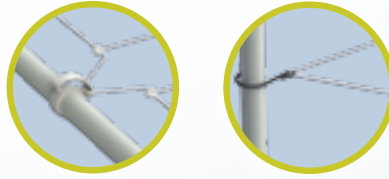

Space Booster

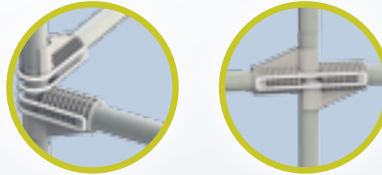

Caoutchouc Feet



47 x T30-F



8 x C30-Y



12 x C30-T



6 x C30-H



42 x C30-L

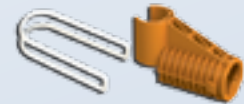

16 x C30-SBR



2 x WebiT150

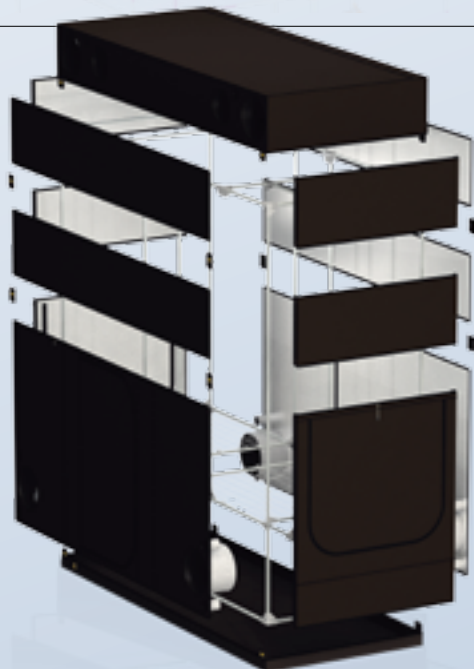

HookIT



StrapIT



CableIT

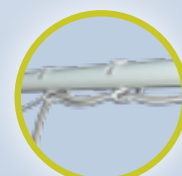



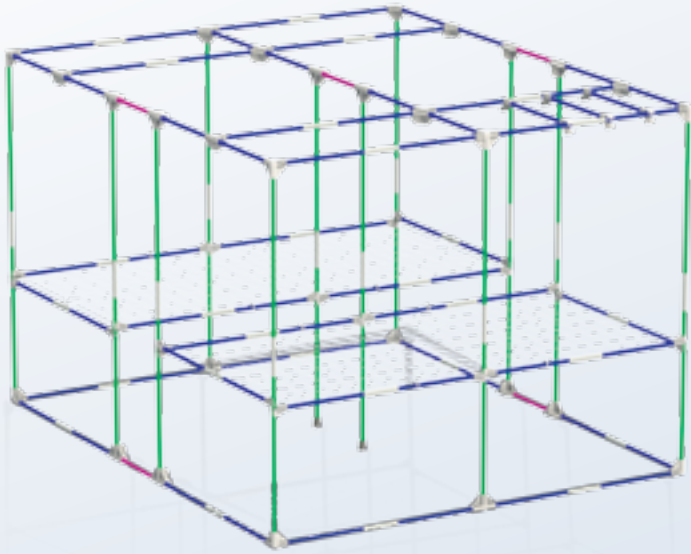

**WebIT**

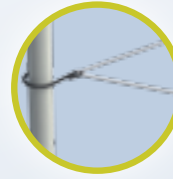
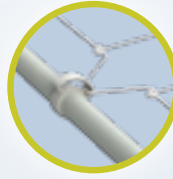

24 x T30-C

**Space Booster**

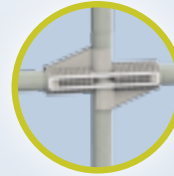
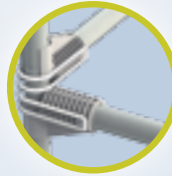

71 x T30-F

**Caoutchouc Feet**



5 x T30-G

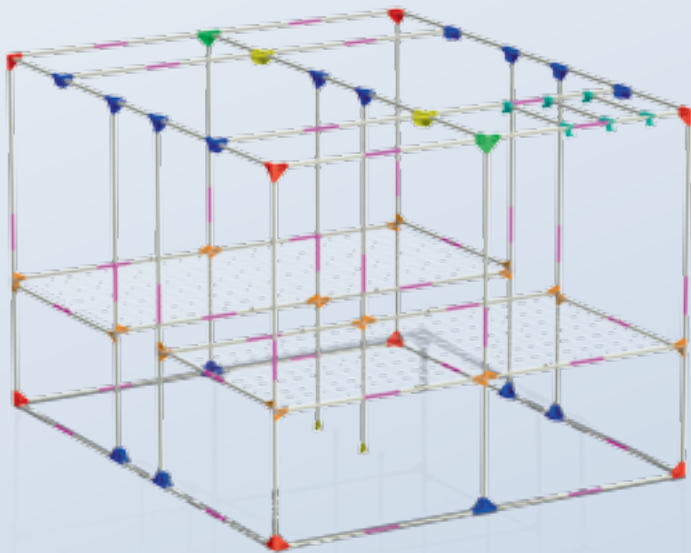

8 x C30-Y



2 x C30-K

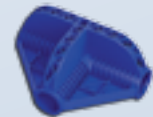

16 x C30-T

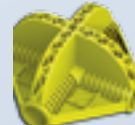

2 x C30-x



6 x C30-H



2 x C30-FR



40 x C30-L



40 x C30-SB



40 x CR30-SBR

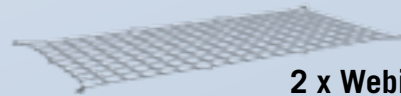

2 x WebiT300w

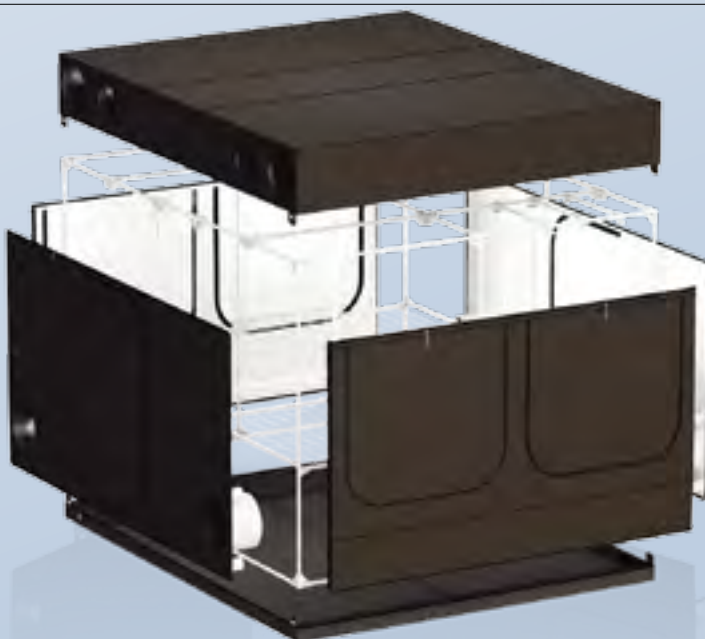

**HookIT**



**StrapIT**



**CableIT**

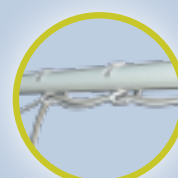

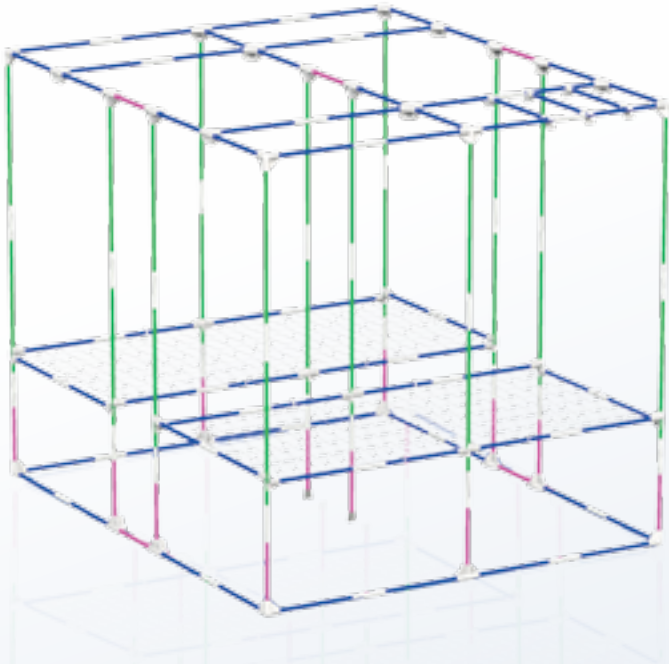

**WebIT**

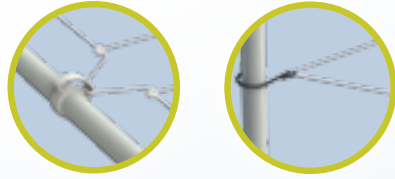

24 x T30-C

**Space Booster**

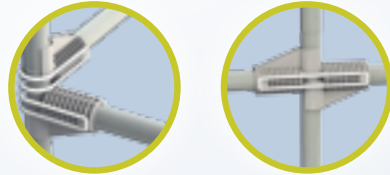

71 x T30-F

**Caoutchouc Feet**



17 x T30-G



8 x C30-Y



2 x C30-K



16 x C30-T

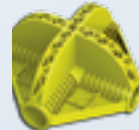

2 x C30-x



6 x C30-H



2 x C30-FR



52 x C30-L



40 x C30-SB



40 x CR30-SBR

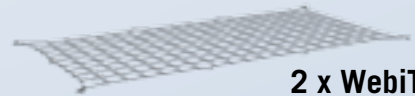

2 x WebiT300w

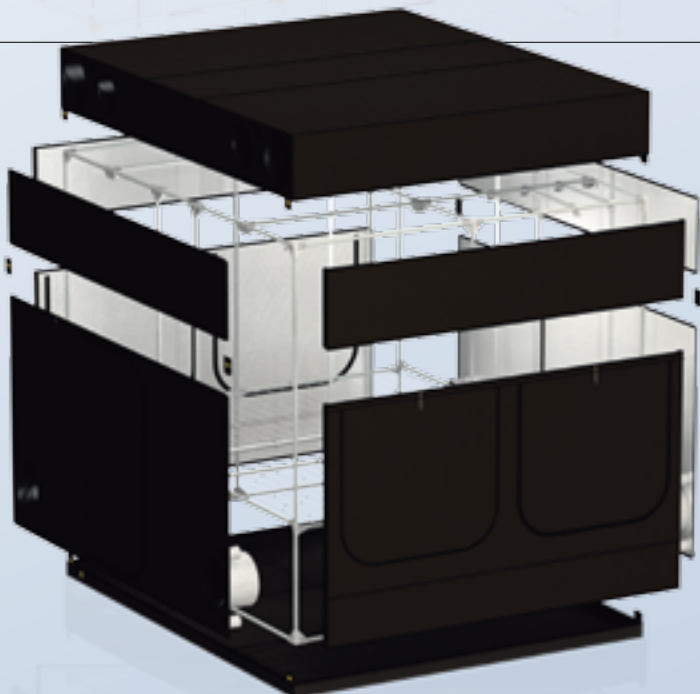

**HookIT**



**StrapIT**



**CableIT**

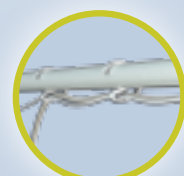

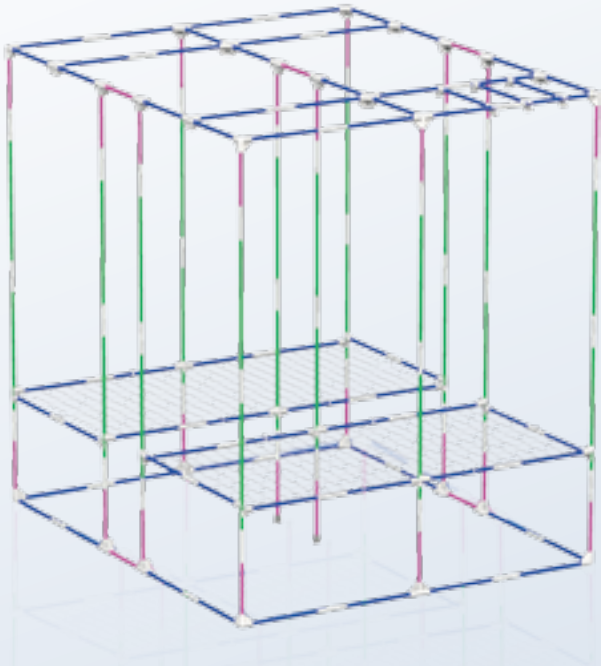

WebIT

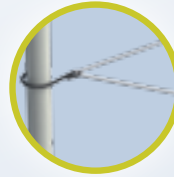
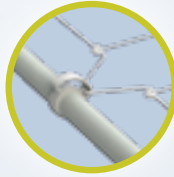

24 x T30-C

Space Booster

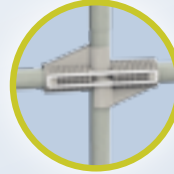
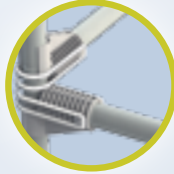

71 x T30-F

Caoutchouc Feet



29 x T30-G



8 x C30-Y

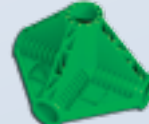

2 x C30-K

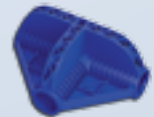

16 x C30-T



2 x C30-x



6 x C30-H



2 x C30-FR



64 x C30-L



40 x C30-SB  
40 x CR30-SBR

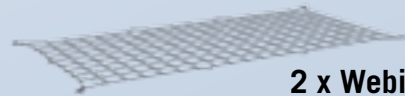

2 x WebiT300w

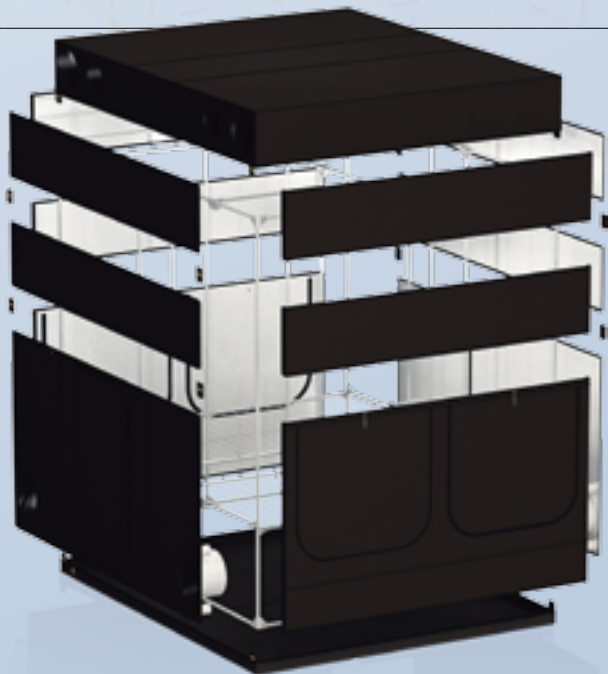

HookIT



StrapIT



CableIT

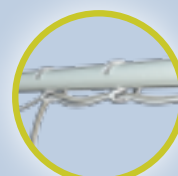

HookIT

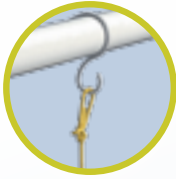

StrapIT

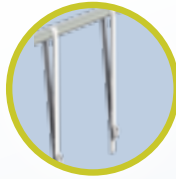

CableIT

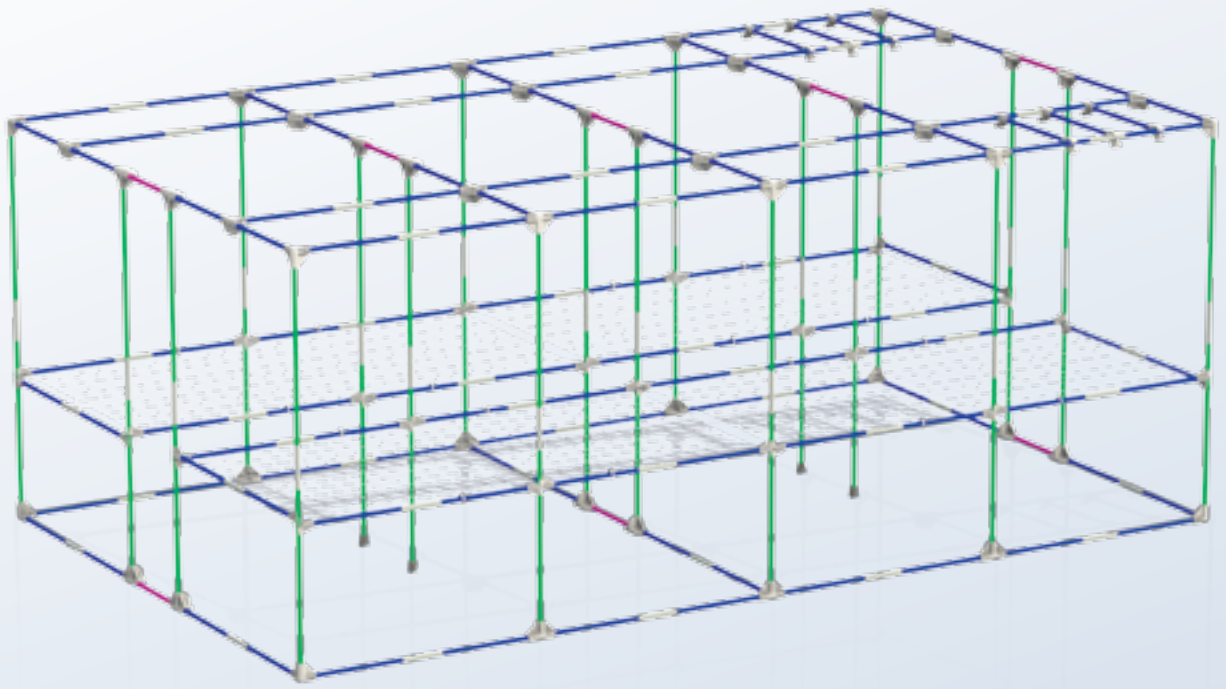
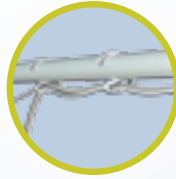

WebIT

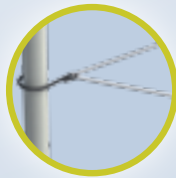

Space Booster

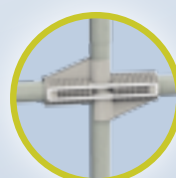

Caoutchouc Feet



40 x T30-C

126 x T30-F

8 x T30-G



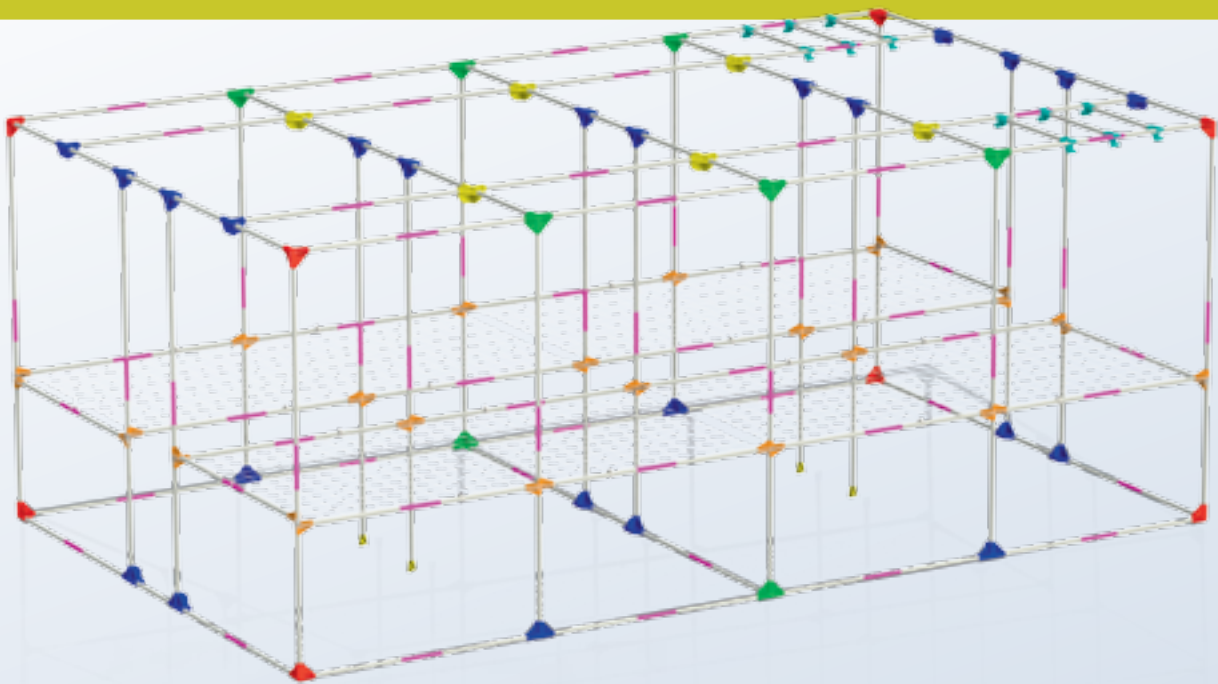

8 x C30-Y



8 x C30-K



24 x C30-T



6 x C30-X



12 x C30-H



4 x C30-RF



40 x C30-SB  
40 x CR30-SBR

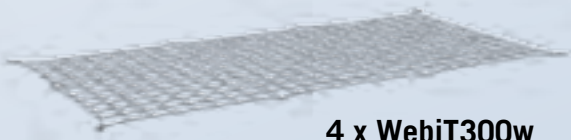

4 x WebiT300w



70 x C30-L

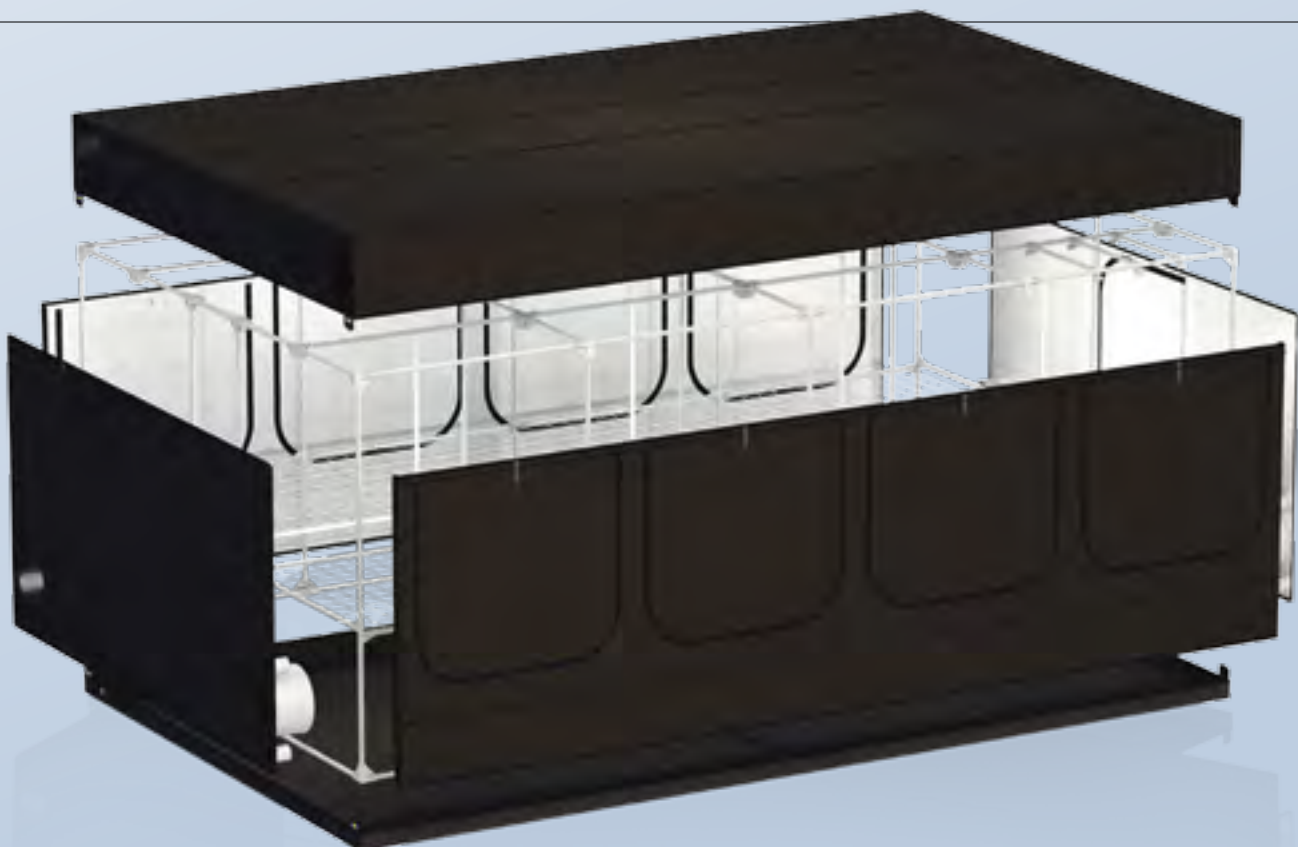

HookIT



StrapIT



CableIT

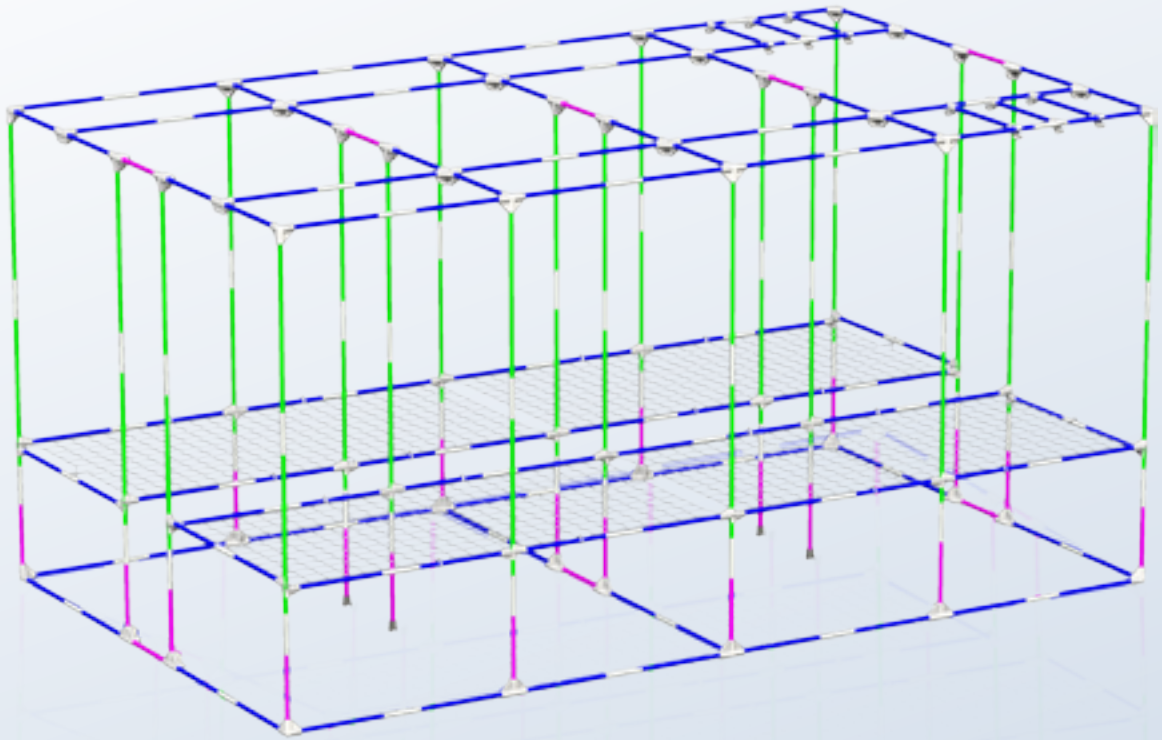
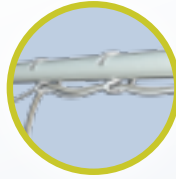

WebIT

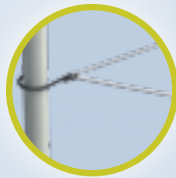
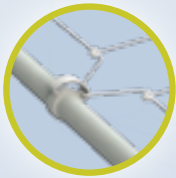

Space Booster

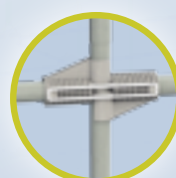

40 x T30-C

126 x T30-F







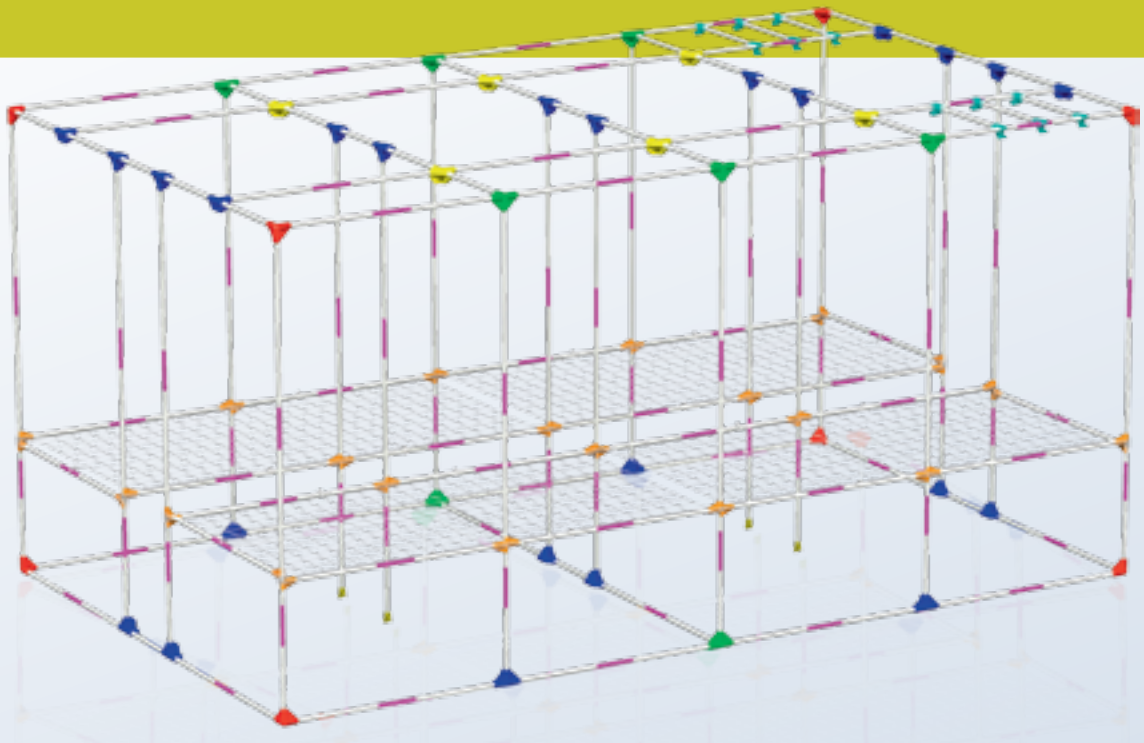

Caoutchouc Feet

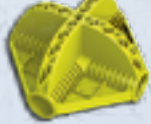

28 x T30-G



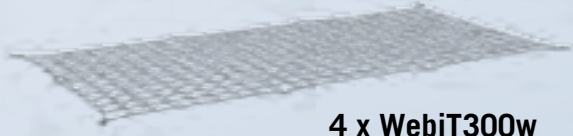

-   
8 x C30-Y
-   
8 x C30-K
-   
24 x C30-T
-   
6 x C30-X
-   
12 x C30-H
-   
4 x C30-RF
-   
40 x C30-SB  
40 x CR30-SBR
-   
4 x WebiT300w
-   
90 x C30-L



HookIT



StrapIT

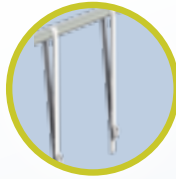

CableIT

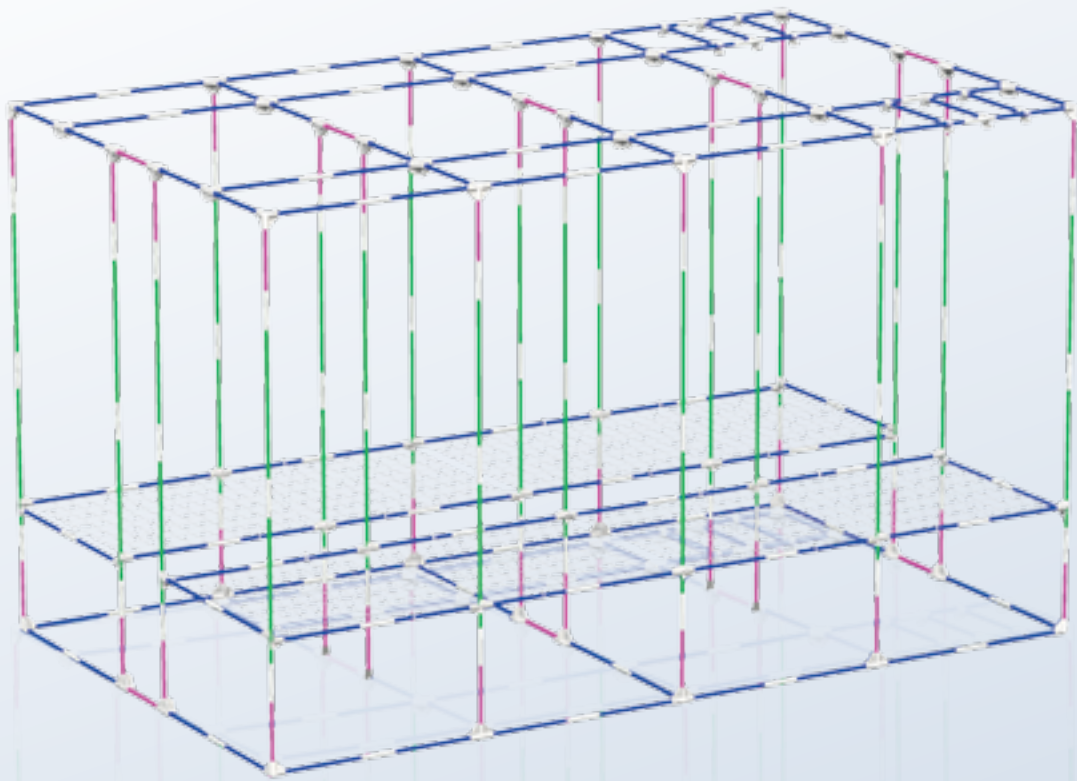
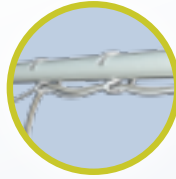

WebIT

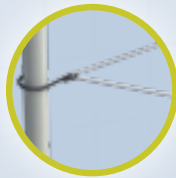
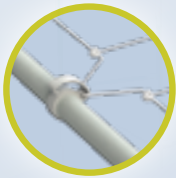

Space Booster

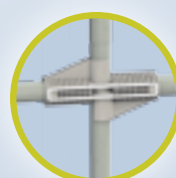

40 x T30-C

126 x T30-F







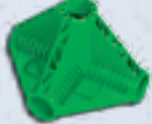

48 x T30-G

Caoutchouc Feet

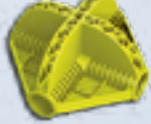



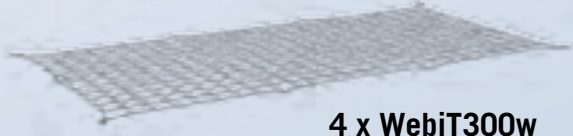

-   
**8 x C30-Y**
-   
**8 x C30-K**
-   
**24 x C30-T**
-   
**6 x C30-X**
-   
**12 x C30-H**
-   
**4 x C30-RF**
-   
**40 x C30-SB  
40 x CR30-SBR**
-   
**4 x WebiT300w**
-   
**110 x C30-L**

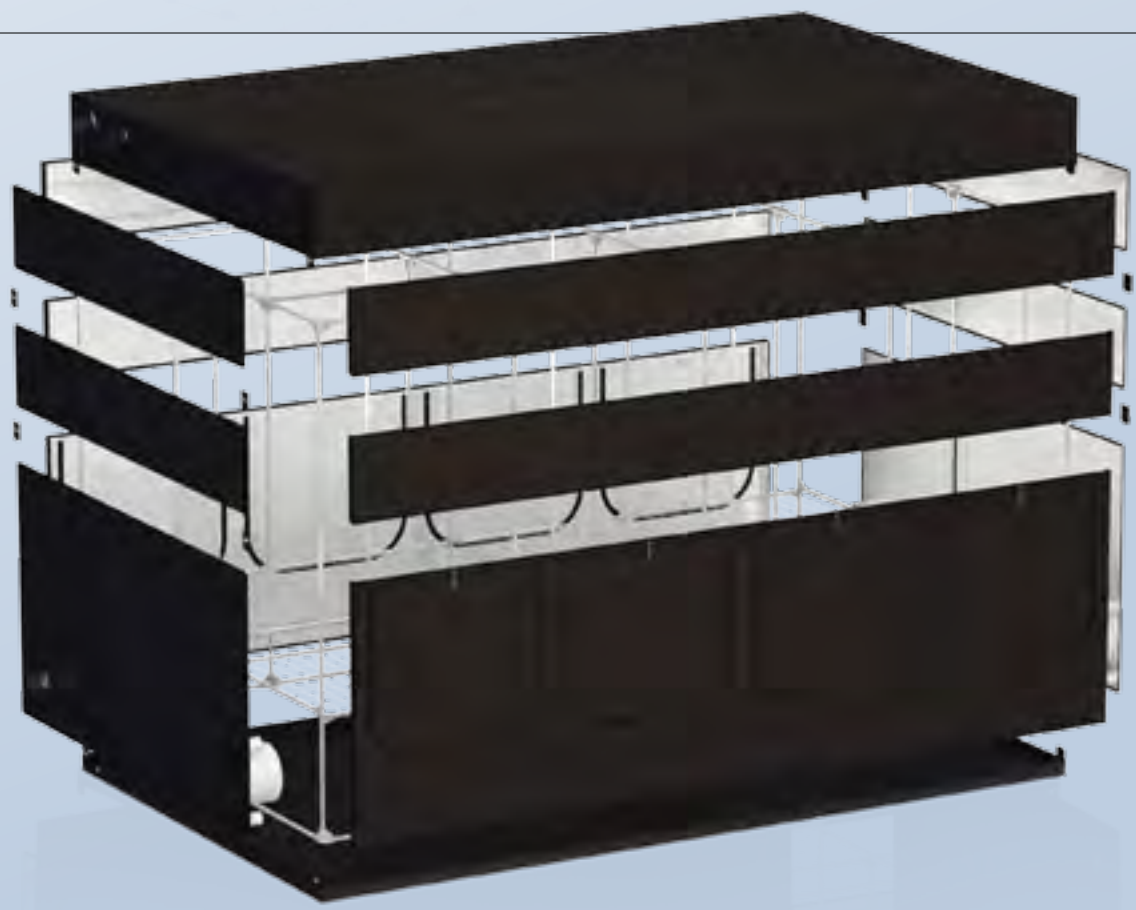



**TENTS CONTENTS**

EXPERT	DESIGNATION	DESIGNATION	INT120	INT240
T30-B	Pole Ø30 mm 1020 mm long	Pole Ø1.2" 40.2" long	16	24
T30-C	Pole Ø30 mm 1157 mm long	Pole Ø1.2" 45.5" long	18	28
T30-D	Pole Ø30 mm 268 mm long	Pole Ø1.2" 10.5" long		
T30-F	Pole Ø30 mm 712,5 mm long	Pole Ø1.2" 28.1" long		
T30-G	Pole Ø30 mm 562,5 mm long	Pole Ø1.2" 22.2" long	15	20
C30-Y	Corner Ø30 mm 3 axes Y shape	Corner Ø1.20" 3 axes Y shape	8	8
C30-K	Corner Ø30 mm 4 axes K shape	Corner Ø1.20" 4 axes K shape		2
C30-T	Corner Ø30 mm 3 axes T shape	Corner Ø1.20" 4 axes T Shape	12	16
C30-X	Corner Ø30 mm 4 axes X shape	Corner Ø1.20" 4 axes X shape		2
C30-L	Link Ø30 mm Straight Joint	Link Ø1.20" Straight Joint	8	12
C30-H	Handling Ø30 mm 1 axe I shape	Corner Ø1.20" Handling	6	6
C30-SB	Space Booster Ø30 mm 1 axe I shape	Space Booster Ø1.20" 1 axe I shape	16	24
C30-SBR	Space Booster Rubber	Space Booster Rubber	16	24
C30-RF	Rubber Feet Ø30 mm 1 axe I shape	Rubber Feet Ø1.20" 1 axe I shape		2

**TENTS SPECIFICATIONS METRIC**

EXPERT GROW TENTS			WGT	ASSEMBLED			WEBBING	DOUBLE LAYERS SOCK CONFIG							
REF	DESIGNATION	REV	Net kg	L cm	W cm	H cm (option)	WebIT Elastic Web Thread	Extraction Ø (mm) #	Intraction Ø (mm) #	Cables Ø (mm) #	CoolTubes Ø (mm) #				
INT120	Intense 120x300x215 cm	R3.00	46	120	300	215 (245-275)	2 WebIT120	380 4	380 4	75 12	280 4				
INT240	Intense 240x300x215 cm	R3.00	65	240	300	215 (245-275)	2 WebIT240w	380 4	380 4	75 12	280 4				
INT480	Intense 480x300x215 cm	R3.00	102	480	300	215 (245-275)	4 WebIT240w	380 4	380 4	75 12	280 4				
INT150	Intense 150x360x242 cm	R3.00	62	150	360	242 (302-382)	2 WebIT150	380 4	380 4	75 12	280 4				
INT300	Intense 300x360x242 cm	R3.00	84	300	360	242 (302-382)	2 WebIT300w	380 4	380 4	75 12	280 4				
INT600	Intense 600x360x242 cm	R3.00	141	600	360	242 (302-382)	4 WebIT300w	380 4	380 4	75 12	280 4				

**MAIN TECHNO**

Main Fabric : Mylar 900D - Poles Ø30 mm - Plastic Corners 8 mm thick - Water Tray : 800 gr Fibered Liner  
Space Booster Inc. - Web Plant Support Inc - Bag Fabric : 600D

**TENTS SPECIFICATIONS IMPERIAL**

EXPERT GROW TENTS			WGT	ASSEMBLED			WEBBING	DOUBLE LAYERS SOCK CONFIG							
REF	DESIGNATION	REV	Net lb	L in	W in	H in (option)	WebIT (Elastic) Web (Thread)	Extraction Ø (in) #	Intraction Ø (in) #	Cables Ø (in) #	CoolTubes Ø (in) #				
INT120	Intense 4' x 10' x 7'	R3.00	101	47	118	85 (97-108)	2 WebIT120	15 4	15 4	3 12	11 4				
INT240	Intense 8' x 10' x 7'	R3.00	143	94,5	118	85 (97-108)	2 WebIT240w	15 4	15 4	3 12	11 4				
INT480	Intense 16' x 10' x 7'	R3.00	225	189	118	85 (97-108)	4 WebIT240w	15 4	15 4	3 12	11 4				
INT150	Intense 5' x 12' x 8'	R3.00	115	59	141,5	95 (119-142)	2 WebIT150	15 4	15 4	3 12	11 4				
INT300	Intense 10' x 12' x 8'	R3.00	185	118	141,5	95 (119-142)	2 WebIT300w	15 4	15 4	3 12	11 4				
INT600	Intense 20' x 12' x 8'	R3.00	311	236	141,5	95 (119-142)	4 WebIT300w	15 4	15 4	3 12	11 4				

**MAIN TECHNO**

Main Fabric : Mylar 900D - Poles Ø1.20" - Plastic Corners 0.3" thick - Water Tray : 800 gr Fibered Liner  
Space Booster Inc. - Web Plant Support Inc - Bag Fabric : 600D



ENT480	ENT150	ENT300	ENT600	ENT1200	ENT2400	ENT4800	ENT1500	ENT3000	ENT6000
40									
50	16	24	40						
	47	71	126	8	12	20			
34	4	5	8				8	12	20
8	8	8	8						
8		2	8						
24	12	16	24						
6		2	6						
20	26	40	70	8	12	20	8	12	20
12	6	6	12						
40	16	24	40						
40	16	24	40						
4		2	4						

HANDLING		ACCESSORIES			LIGHTING ADVISED		VOL	EXTRACTION ADVISED				GROW AREAS		
Poles #	Weight Max/Pole	Strap/T Pair #	Hook/T Pair #	Cable/T #	Cool Tube HPS 2000°K	LED	m3	HPS (every 30-60s)		LED (every 1-2 min)		#	Inside Poles L (cm)	W (cm)
								Extraction	Intake	Extraction	Intake			
3	35 kg	2	4	30	2x HPS600W	2x LED400W	7,7	930 m3/h	465 m3/h	460 m3/h	230 m3/h	2	113	113
3	35 kg	2	8	45	4x HPS600W	4x LED400W	15,5	1860 m3/h	930 m3/h	930 m3/h	465 m3/h	2	233	113
6	35 kg	2	16	60	8x HPS600W	8x LED400W	31,0	3720 m3/h	1860 m3/h	1860 m3/h	930 m3/h	2	473	113
3	35 kg	2	4	30	2x HPS1000W	2x LED600W	13,1	1570 m3/h	785 m3/h	780 m3/h	390 m3/h	2	143	143
3	35 kg	2	8	45	4x HPS1000W	4x LED600W	26,1	3140 m3/h	1570 m3/h	1570 m3/h	785 m3/h	2	293	143
6	35 kg	2	16	60	8x HPS1000W	8x LED600W	52,3	6270 m3/h	3135 m3/h	3140 m3/h	1570 m3/h	2	593	143

HANDLING		ACCESSORIES			LIGHTING ADVISED		VOL	EXTRACTION ADVISED				GROW AREAS		
Poles #	Weight Max/Pole	Strap/T Pair #	Hook/T Pair #	Cable/T #	Cool Tube HPS 2000°K	LED	cf	HPS (every 30-60s)		LED (every 1-2 min)		#	Inside Poles L (in)	W (in)
								Extraction	Intake	Extraction	Intake			
3	75 lb	2	4	30	2x HPS600W	2x LED400W	271	541 m3/h	271 m3/h	271 m3/h	135 m3/h	2	44,5	44,5
3	75 lb	2	8	45	4x HPS600W	4x LED400W	544	1088 m3/h	544 m3/h	544 m3/h	272 m3/h	2	92	44,5
6	75 lb	2	16	60	8x HPS600W	8x LED400W	1088	2177 m3/h	1088 m3/h	1088 m3/h	544 m3/h	2	186	44,5
3	75 lb	2	4	30	2x HPS1000W	2x LED600W	458	916 m3/h	458 m3/h	458 m3/h	229 m3/h	2	56	56,5
3	75 lb	2	8	45	4x HPS1000W	4x LED600W	916	1832 m3/h	916 m3/h	916 m3/h	458 m3/h	2	115,5	56,5
6	75 lb	2	16	60	8x HPS1000W	8x LED600W	1832	3665 m3/h	1832 m3/h	1832 m3/h	916 m3/h	2	233,5	56,5





[www.secretjardin.com](http://www.secretjardin.com) - [info@secretjardin.com](mailto:info@secretjardin.com)

Q2 - 2016