



SECRET JARDIN



## ASSEMBLY INSTRUCTIONS

# HOBBY

■ DARK STREET .....	p 2
■ VINTAGE .....	p 8
■ TWIN .....	p 9
■ LODGE .....	p 11
■ CRISTAL ROOM .....	p 15
■ DARK PROPAGATION .....	p 16
■ DARK DRYER .....	p 19
■ SPECIFICATIONS .....	p 20



WebIT

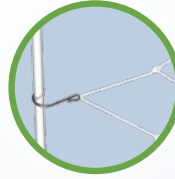

Space Booster

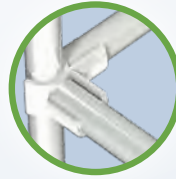

8 x T16-B

14 x T16-A

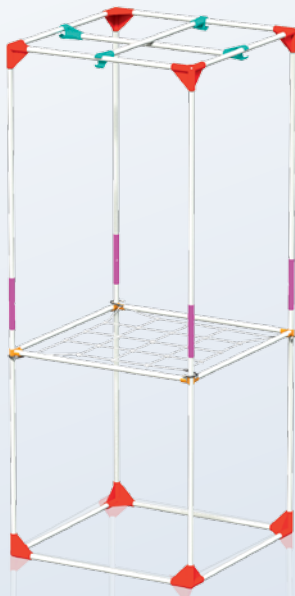

8 x C16-Y

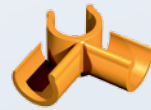

4 x C16-SB



4 x C16-H



4 x C16-L

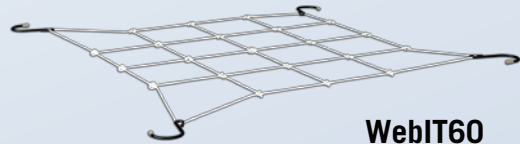

WebIT60



StrapIT

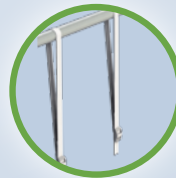

HookIT



CableIT

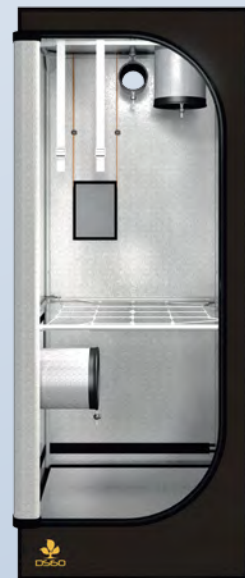
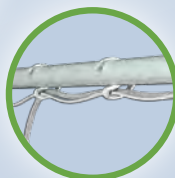

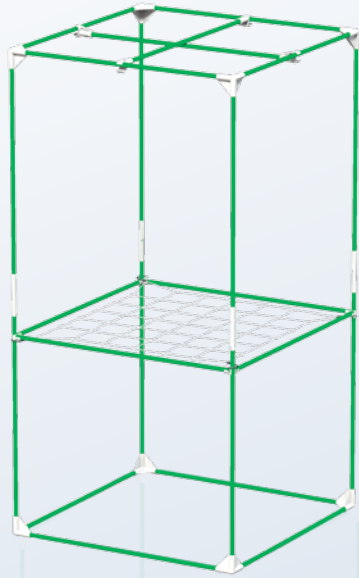

WebIT

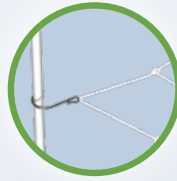

22 x T16-C

Space Booster

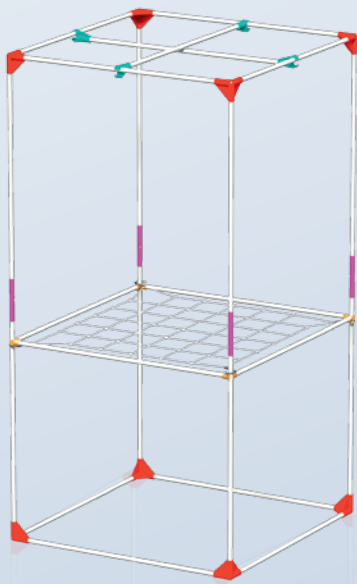

8 x C16-Y



4 x C16-SB



4 x C16-H



4 x C16-L

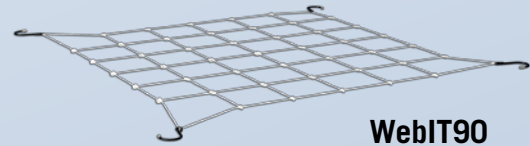

WebIT90

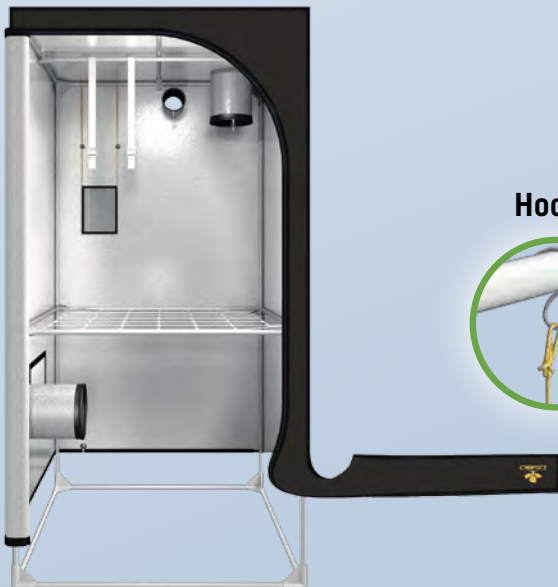

StrapIT

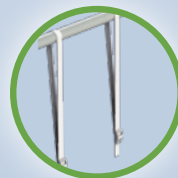

HookIT



CableIT

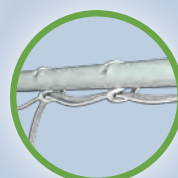

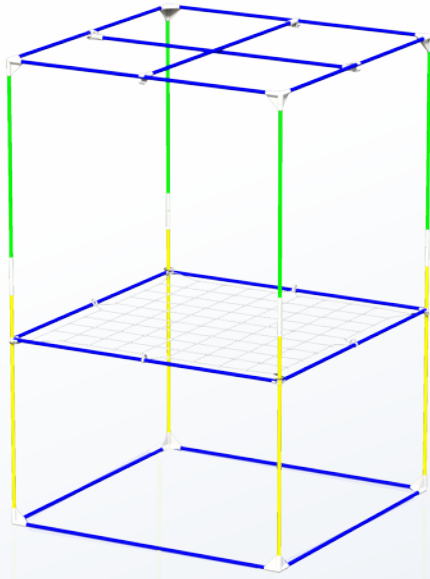

WebIT

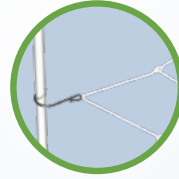

Space Booster

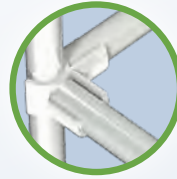

14 x T16-E

4 x T16-D

4 x T16-C

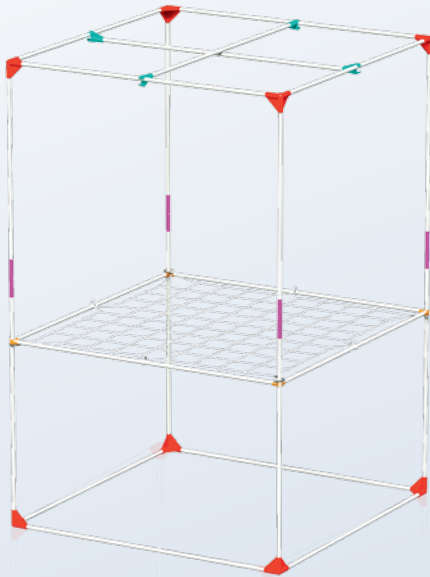

8 x C16-Y

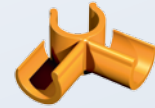

4 x C16-SB



4 x C16-H



4 x C16-L

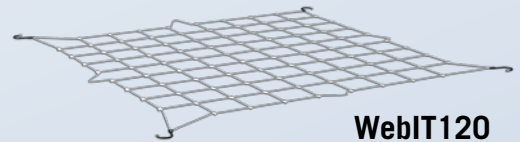

WebIT120



HookIT



StrapIT

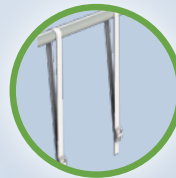

CableIT

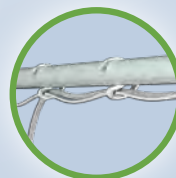

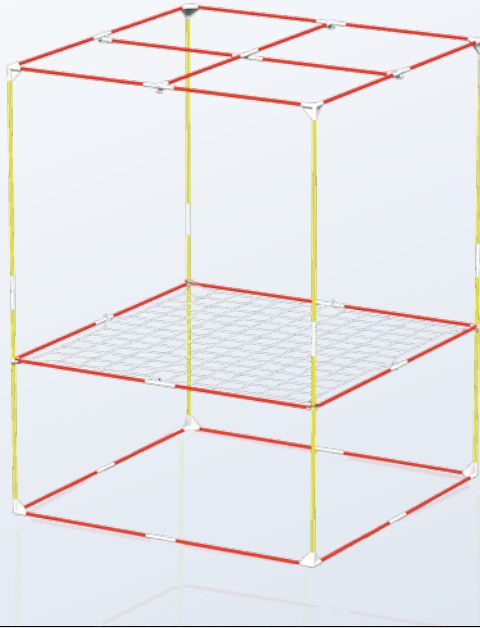

WebIT

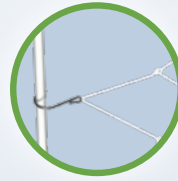

8 x T16-D

28 x T16-B

Space Booster

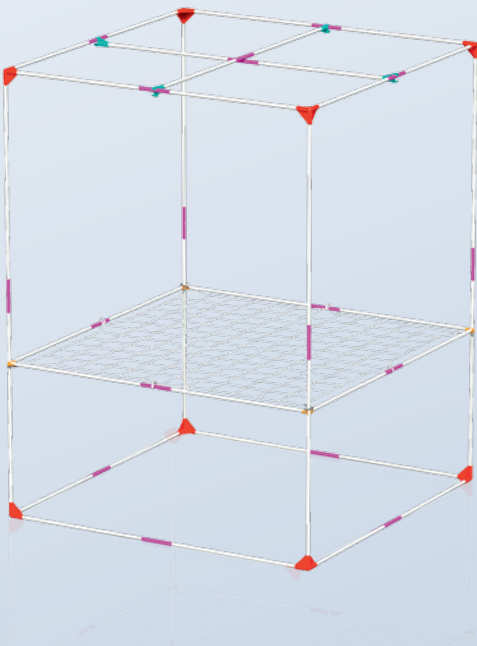

8 x C16-Y



4 x C16-SB

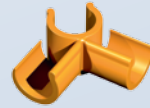

4 x C16-H



18 x C16-L

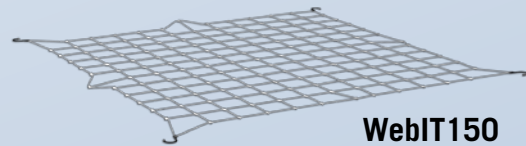

WebIT150



HookIT



StrapIT

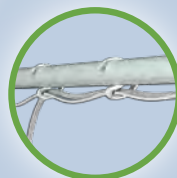
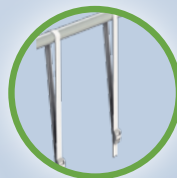

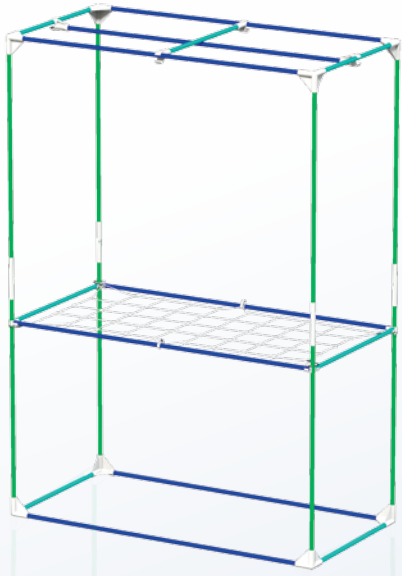

WebIT

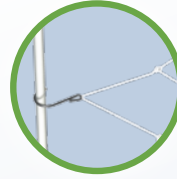

7 x T16-E

8x T16-C

Space Booster



7 x T16-A

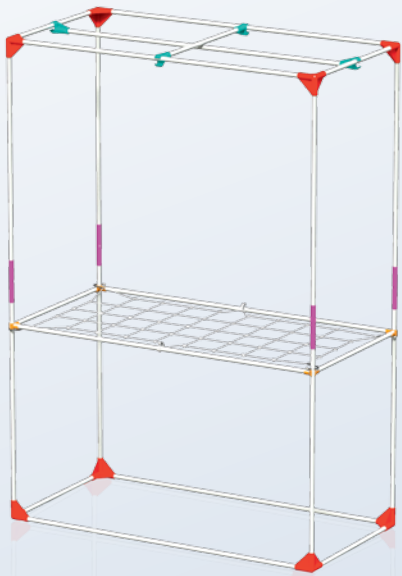

8 x C16-Y

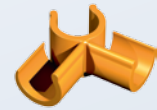

4 x C16-SB



4 x C16-H



4 x C16-L

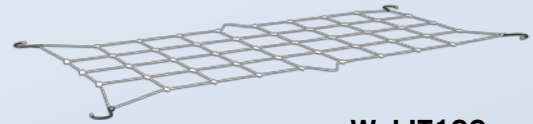

WebIT120w



HookIT



StrapIT

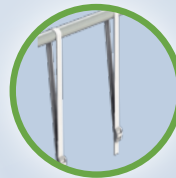

CableIT

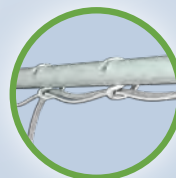

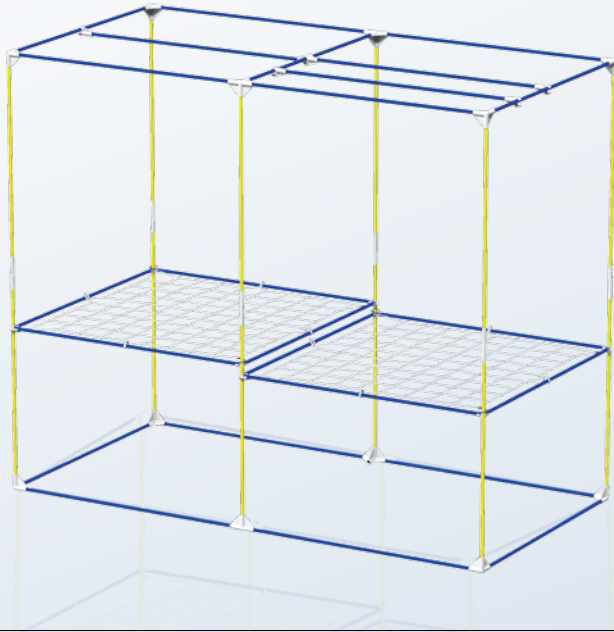

**WebIT**

**24 x T16-E**

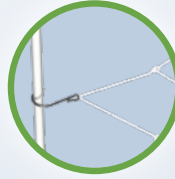

**12 x T16-D**

**Space Booster**

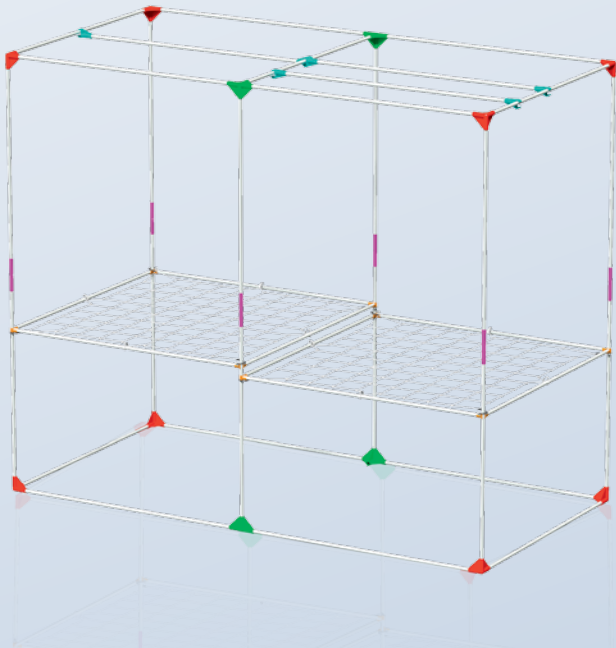

**8 x C16-Y**

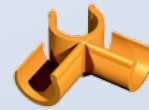

**8 x C16-SB**



**4 x C16-K**



**6 x C16-H**



**6 x C16-L**

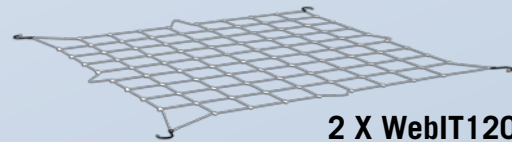

**2 X WebIT120**

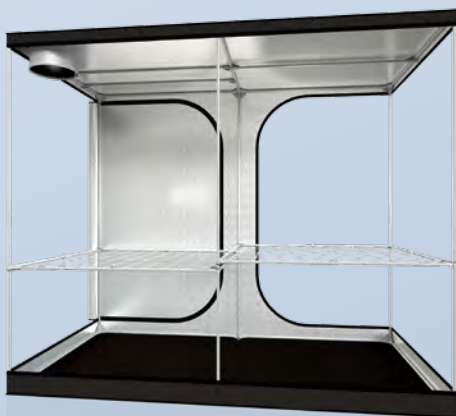

**HookIT**



**StrapIT**

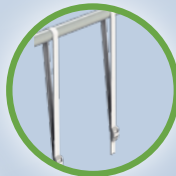

**CableIT**

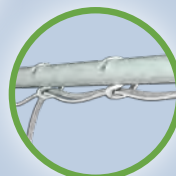

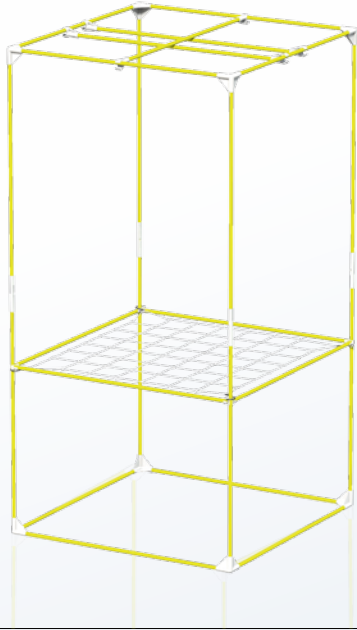

WebIT

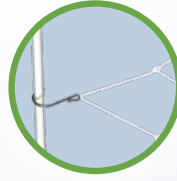

23 x T16-D

Space Booster

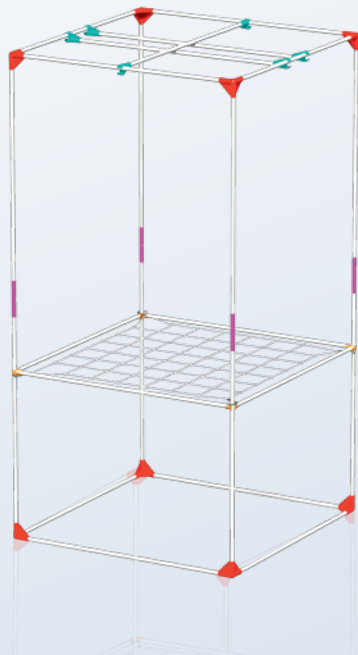

8 x C16-Y

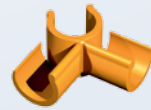

4 x C16-SB



6 x C16-H



4 x C16-L

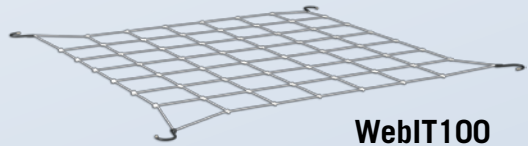

WebIT100

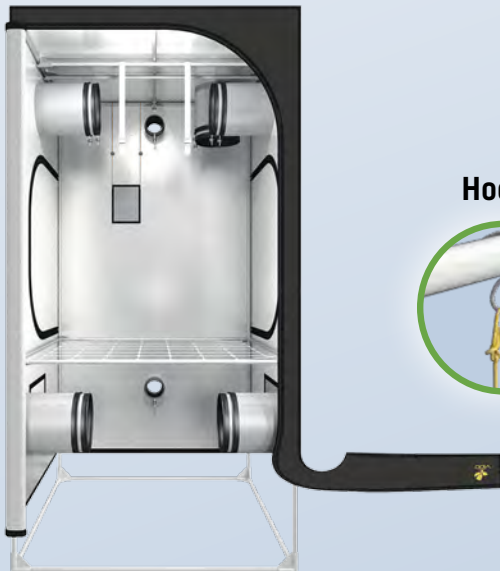

StrapIT

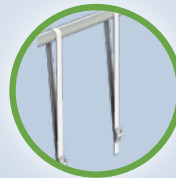

HookIT



CableIT

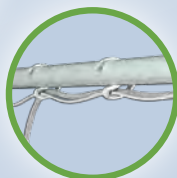



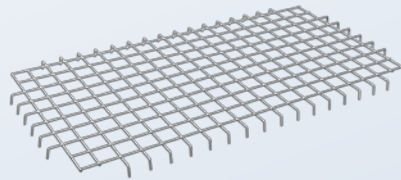

2 x GS 60.30

8 x T16-B

15 x T16-A

4 x T16-F

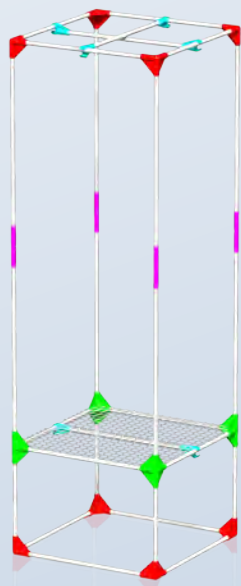

8 x C16-Y



4 x C16-K



6 x C16-H



4 x C16-L

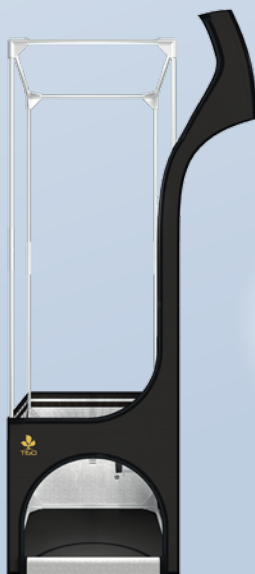
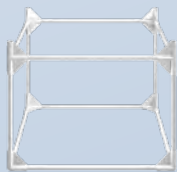
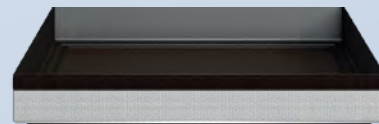

HookIT

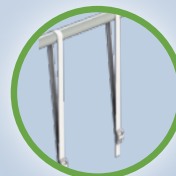

CableIT

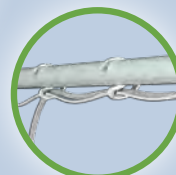

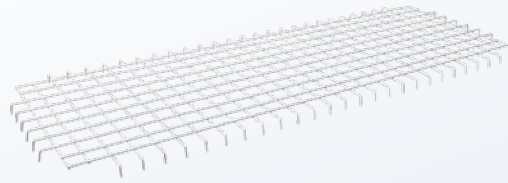
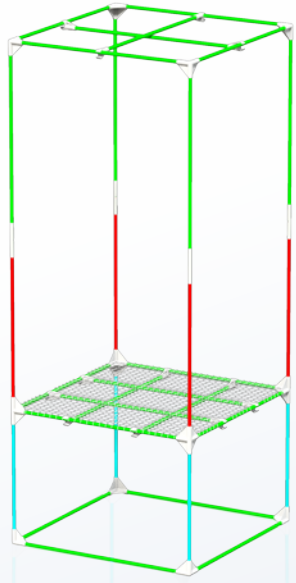

3 x GS 90.30

22 x T16-C

4 x T16-B

4 x T16-A

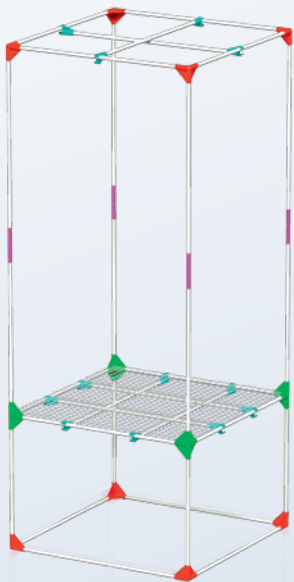

8 x C16-Y



4 x C16-K



12 x C16-H



4 x C16-L

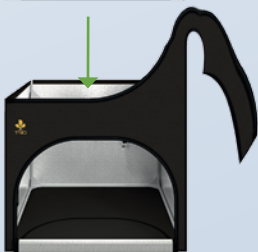
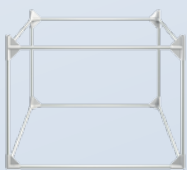
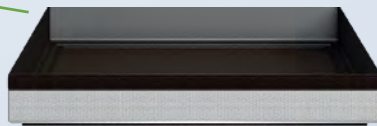

HookIT



StrapIT

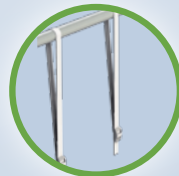

CableIT

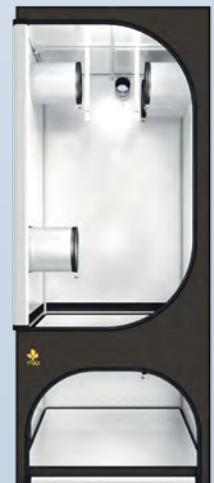
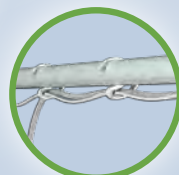

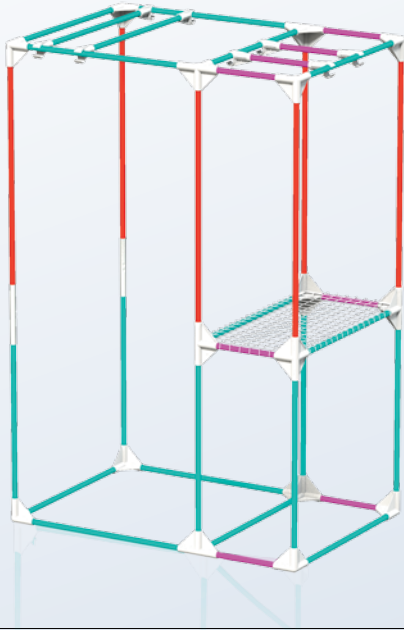

- 6 x T16-B
- 20 x T16-A
- 8 x T16-G

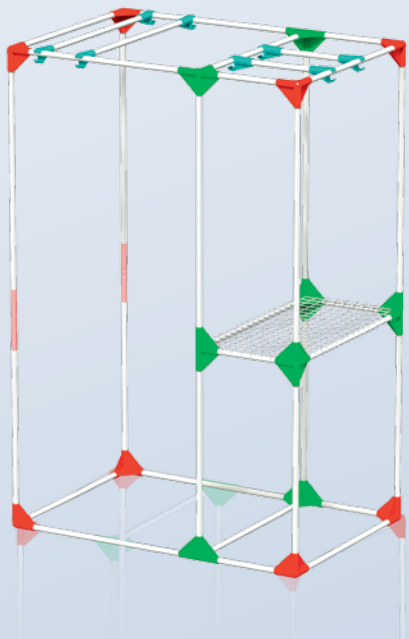

- 8 x C16-Y
- 8 x C16-K
- 8 x C16-H
- 2 x C16-LL
- 1 x GS 60.30

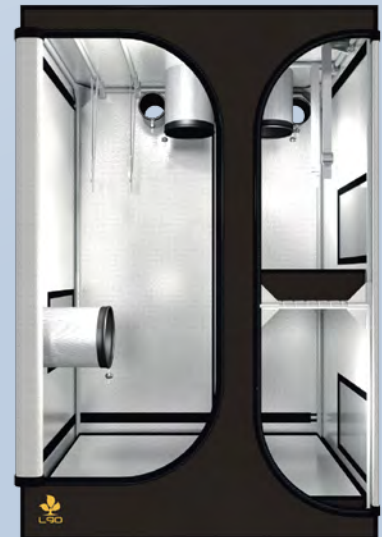
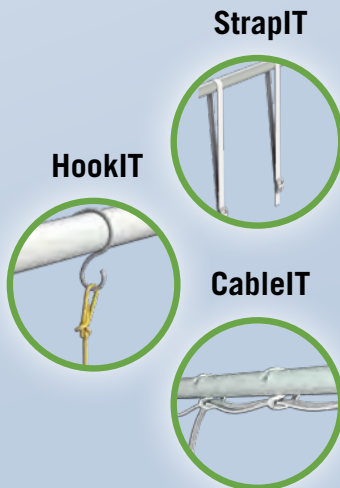
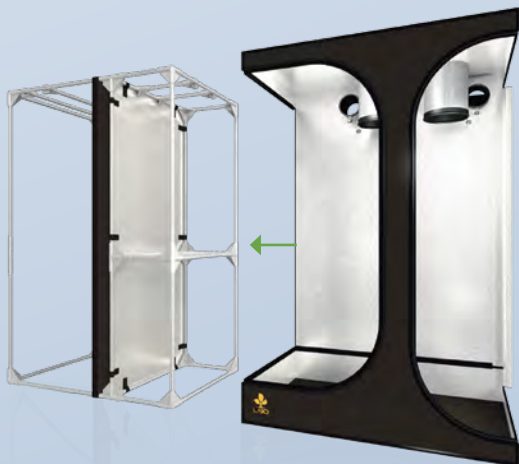

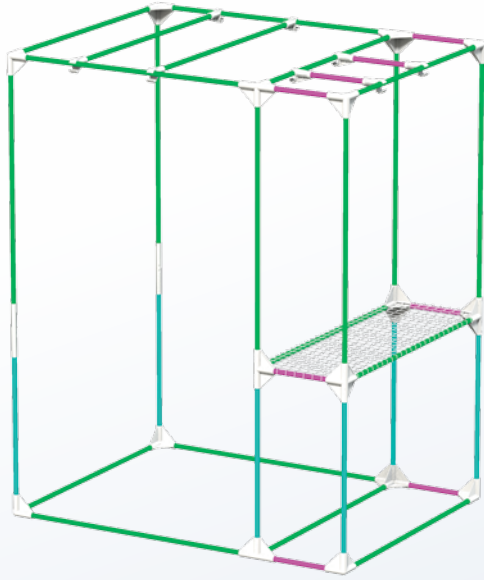

20 x T16-C

6 x T16-A

8 x T16-G

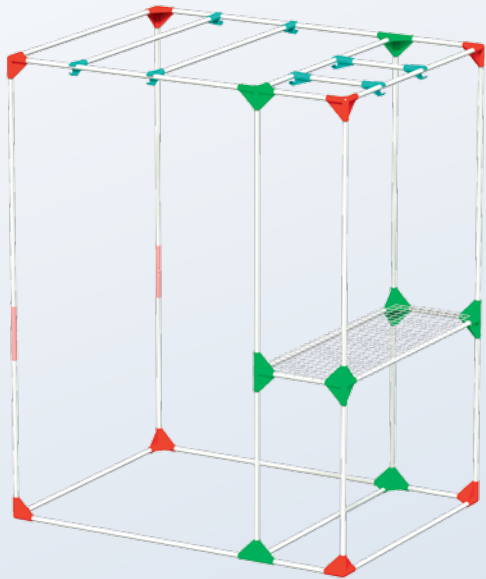

8 x C16-Y



8 x C16-K



8 x C16-H



2 x C16-LL

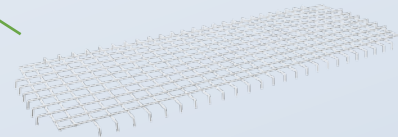

1 x GS 90.30

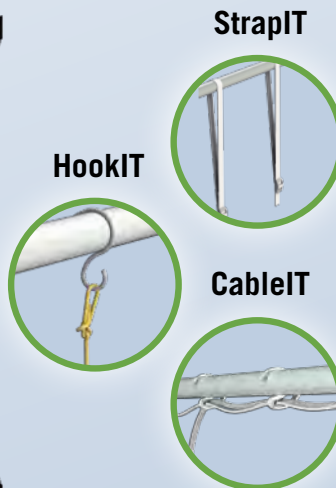
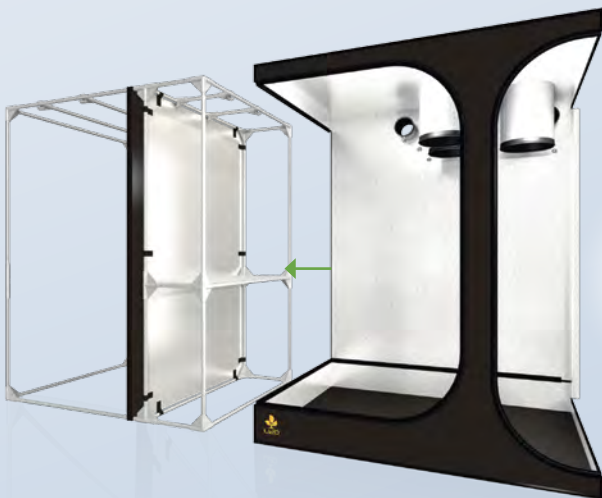

StrapIT

HookIT

CableIT

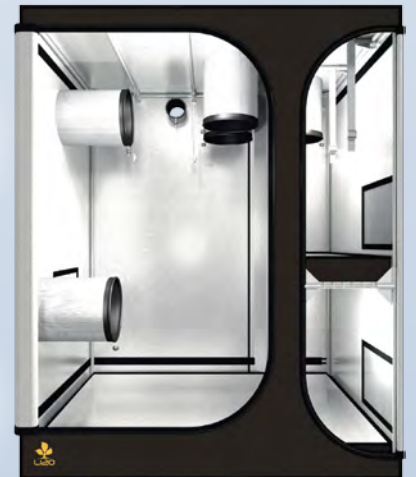

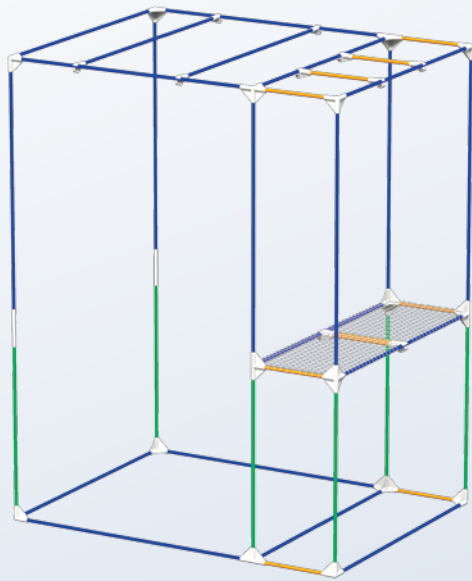

6 x T16-C

20 x T16-E

10 x T16-F

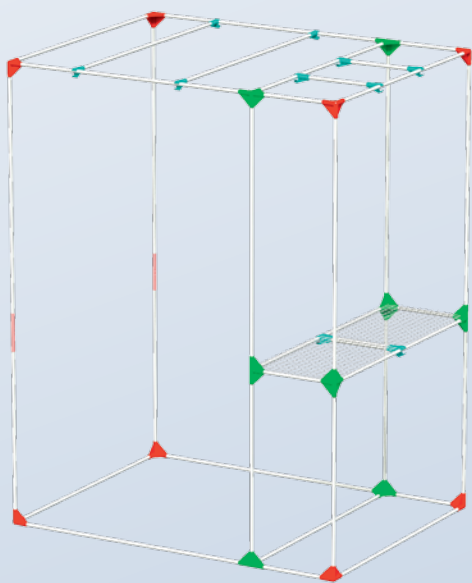

8 x C16-Y

8 x C16-K

12 x C16-H

2 x C16-LL

2 x GS 60.40

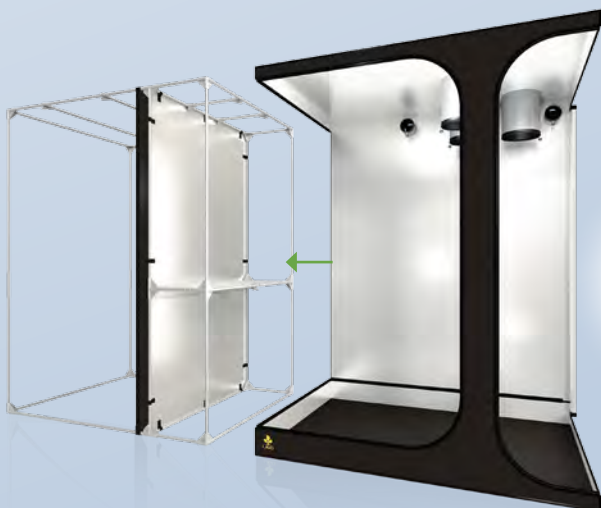

StrapIT

HookIT

CableIT



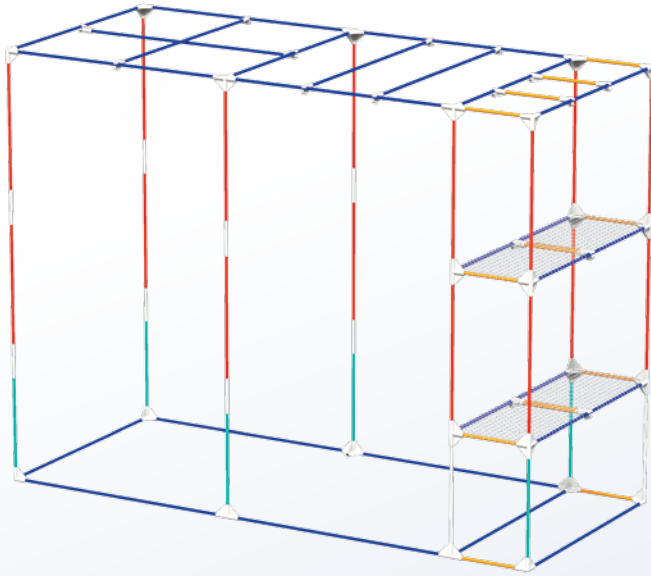

23 x T16-E

16 x T16-B

8 x T16-A

14 x T16-F

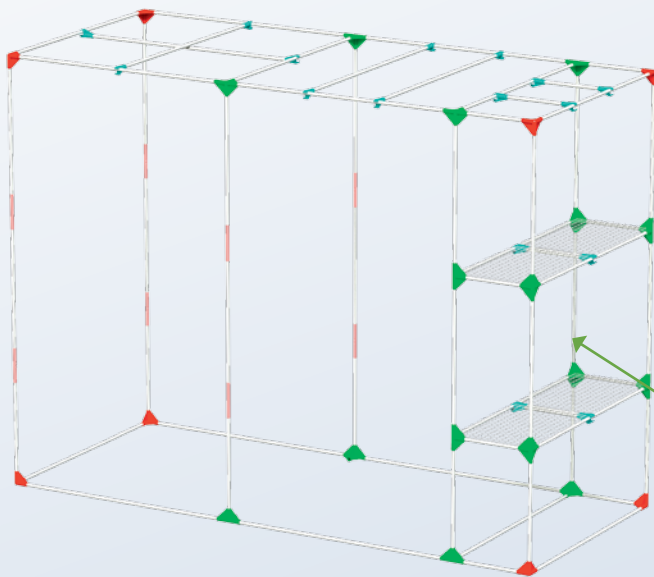
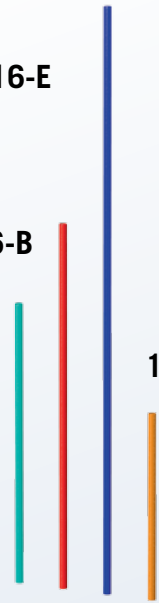

8 x C16-Y



16 x C16-K



20 x C16-H



8 x C16-LL

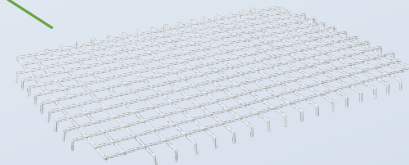

4 x GS 60.40

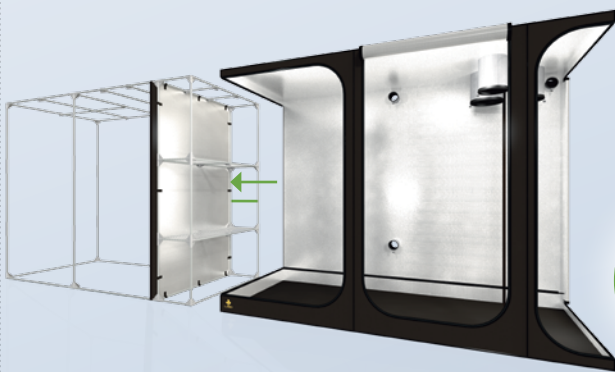

StrapIT

HookIT

CableIT

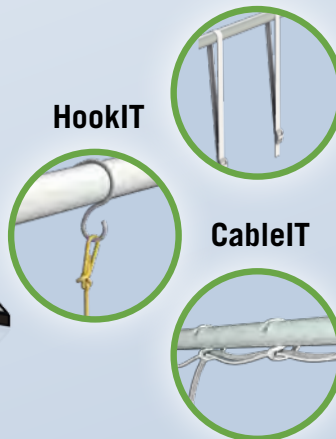

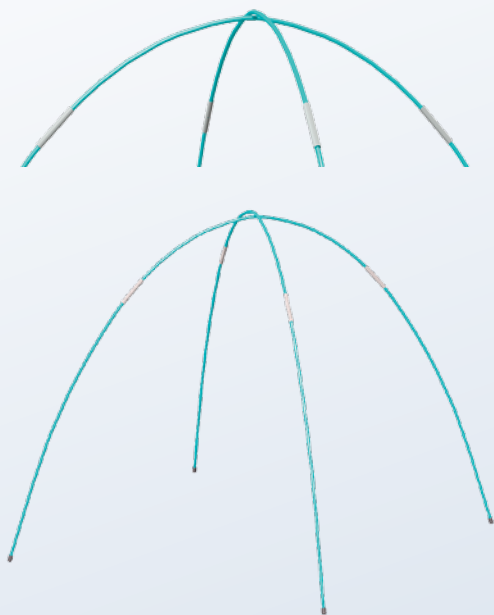

CR60

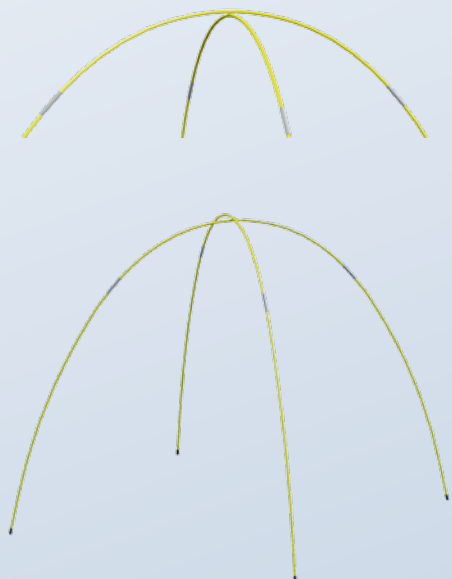

CR110

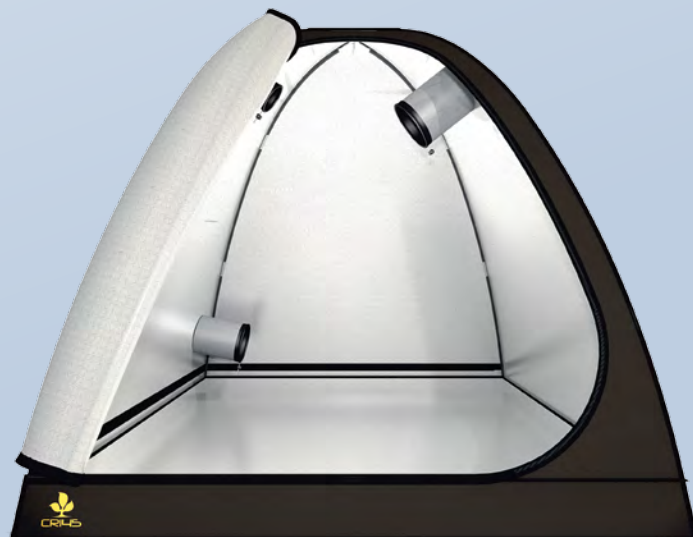

CR145



9 x T16-A



5 x T16-F

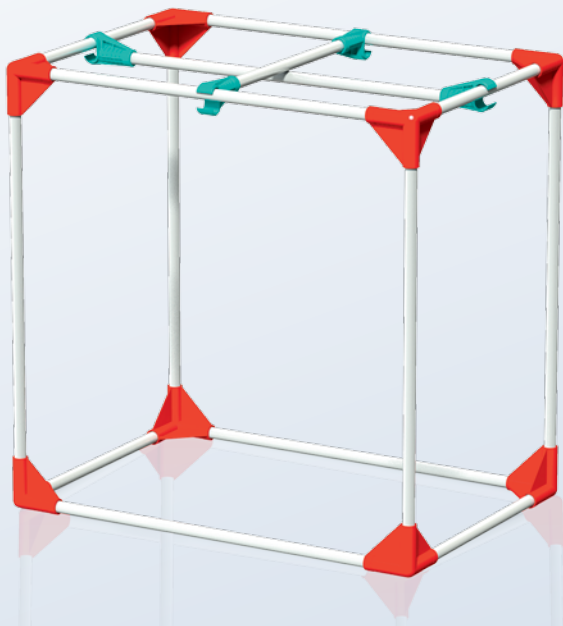

8 x C16-Y



4 x C16-H



StrapIT

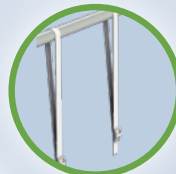

HookIT



CableIT

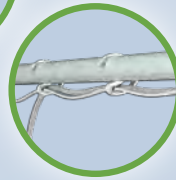



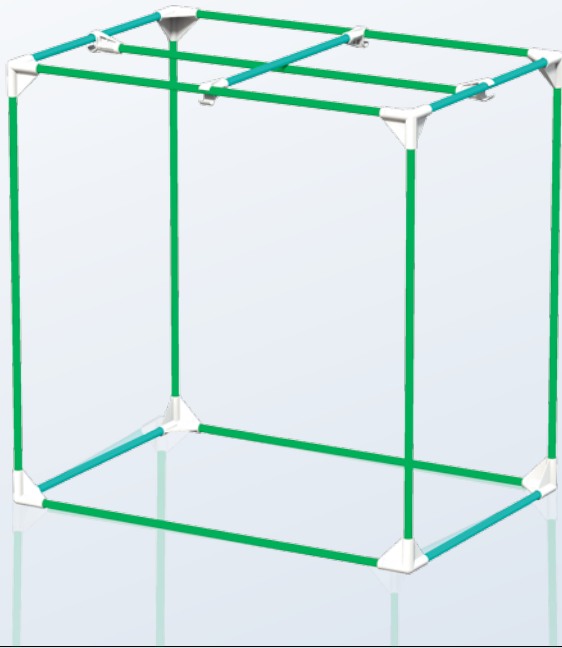

5 x T16-A



9 x T16-C

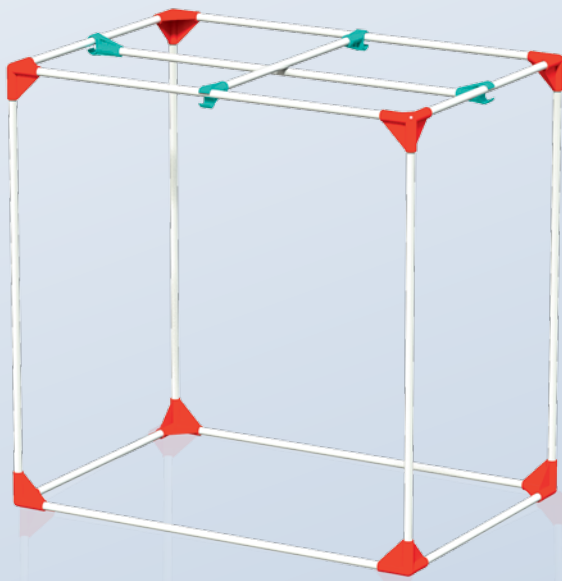

8 x C16-Y



4 x C16-H



StrapIT

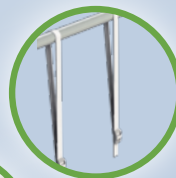

HookIT



CableIT

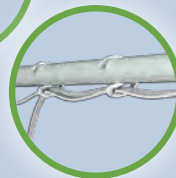

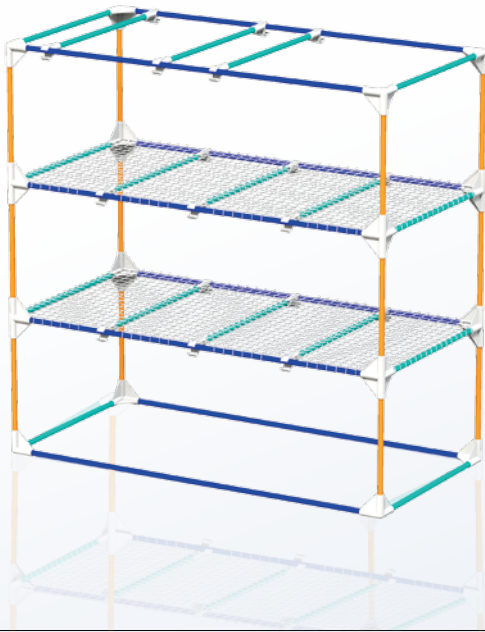

8 x T16-E

18 x T16-A

12 x T16-F

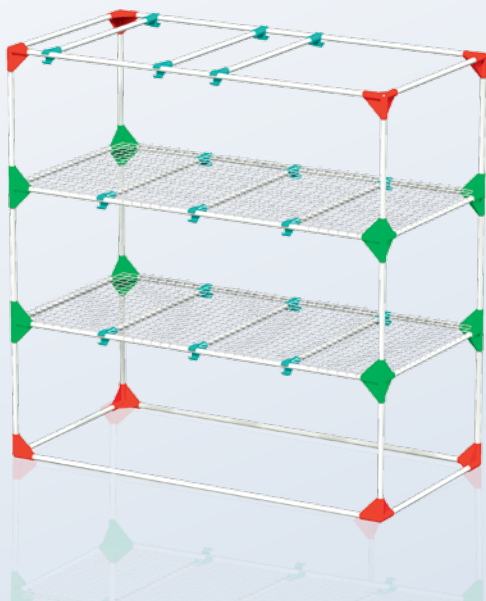

8 x C16-Y

8 x C16-K

20 x C16-H

8 x GS 60.30

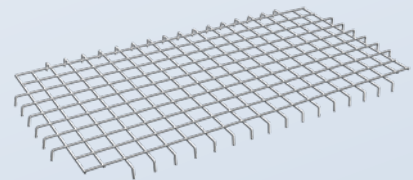

StrapIT

HookIT

CableIT

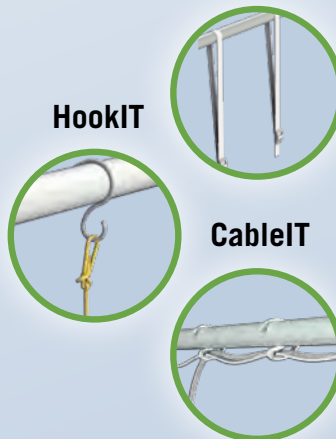

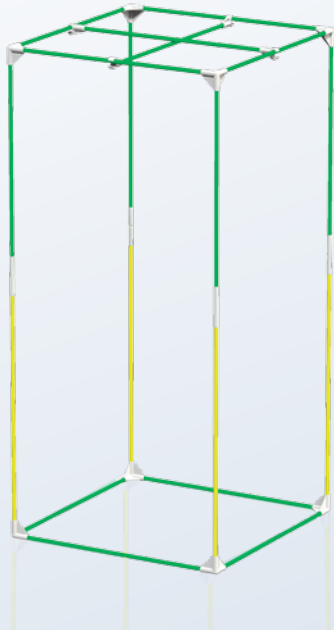

14 x T16-C



4 x T16-D



8 x C16-Y



4 x C16-H



4 x C16-L



StrapIT

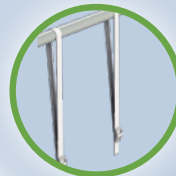

HookIT



CableIT

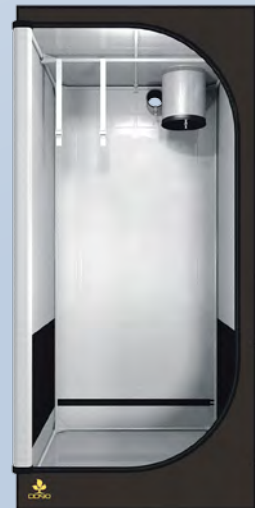
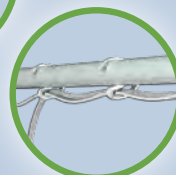

METRIC SYSTEM

HOBBY GROW TENTS		ASSEMBLED		SOCK CONFIG (FLOW / GROW)				HANDLING		ACCESSORIES		LIGHTING ADVISED		VOL		EXTRACTION ADVISED			
REF	DESIGNATION	REV	Net kg	W cm	D cm	H cm	Web/T Elastic Web Thread	Extraction Ø (mm)	Intracation Ø (mm)	Cables Ø (mm)	CoolTubes Ø (mm)	Poles Max/Pole	StrapIT HookIT Cablett Pair #	Cool Tube HPS 2000°K	Led	m3	HPS (every 30-60s) Extraction Intake	LED (every 1-2 min) Extraction Intake	
DS60	Dark Street 60x60x150 cm	R3.00	5.4	60	60	150	1 Web60	150	150	75	1	2	1	1x HPS250W	1x LED150W	0.5	65 m3/h	30 m3/h	
DS90	Dark Street 90x90x170 cm	R3.00	7.5	90	90	170	1 Web90	150	150	75	1	2	1	1x HPS400W	1x LED300W	1.4	165 m3/h	85 m3/h	
DS120	Dark Street 120x120x185 cm	R3.00	11.5	120	120	185	1 Web120	200	200	75	1	2	1	1x HPS600W	1x LED400W	2.7	320 m3/h	160 m3/h	
DS150	Dark Street 150x150x200 cm	R3.00	13.8	150	150	200	1 Web150	200	200	75	1	2	1	1x HPS1000W	1x LED600W	4.5	540 m3/h	270 m3/h	
DS120w	Dark Street 120x60x170 cm	R3.00	8.1	120	60	170	1 Web120w	150	150	75	1	2	1	1x HPS400W	1x LED300W	1.2	145 m3/h	75 m3/h	
DS240w	Dark Street 240x120x200 cm	R3.00	17.0	240	120	200	2 Web120	250	250	75	2	3	1	2x HPS400W	2x LED400W	5.8	690 m3/h	345 m3/h	
V100	Vintage 103x103x200 cm	R3.00	10.0	103	103	200	1 Web100	200	200	75	2	3	1	1x HPS400W	2x LED400W	2.1	255 m3/h	125 m3/h	
<b>HOBBY '1/2 ROOMS' GROW TENTS</b>																			
REF	DESIGNATION	REV	Net kg	W cm	D cm	H (cm) Top-Bot.	Web/T Elastic Web Thread	Extraction Ø (mm)	Intracation Ø (mm)	Cables Ø (mm)	CoolTubes Ø (mm)	Poles Max/Pole	StrapIT HookIT Cablett Pair #	Flow Space HPS 2000°K	Grow Space TLED 6500°K	m3	HPS (every 30-60s) Extraction Intake	LED (every 1-2 min) Extraction Intake	
T60	Twin 60x60x190 cm	R2.60	8.4	60	60	150-40	-	150	1/1	150	1/0	75	1/1	1x HPS250W	1x TLED26W	0.5	60 m3/h	30 m3/h	
T90	Twin 90x90x220 cm	R2.60	13.2	90	90	160-60	-	200	1/1	200	1/0	75	1/1	1x HPS400W	2x TLED26W	1.2	140 m3/h	70 m3/h	
<b>HOBBY '1/3 ROOMS' GROW TENTS</b>																			
REF	DESIGNATION	REV	Net kg	W cm	D cm	H (cm) Top-Bot.	Web/T Elastic Web Thread	Extraction Ø (mm)	Intracation Ø (mm)	Cables Ø (mm)	CoolTubes Ø (mm)	Poles Max/Pole	StrapIT HookIT Cablett Pair #	Flow Space HPS 2000°K	Grow Space TLED 6500°K	m3	HPS (every 30-60s) Extraction Intake	LED (every 1-2 min) Extraction Intake	
L90	Lodge 90x60x135 cm	R2.60	9.4	60-30	60	75-60	-	150	1/1	150	1/0	75	1/1	1x HPS250W	1x TLED26W	0.5	60 m3/h	30 m3/h	
L120	Lodge 120x90x145 cm	R2.60	13.0	90-30	90	85-60	-	200	1/1	200	1/0	75	1/1	1x HPS400W	2x TLED26W	1.2	140 m3/h	70 m3/h	
L160	Lodge 160x120x205 cm	R2.60	16.8	120-40	120	120-85	-	200	1/1	200	2/0	4	10 kg	2x HPS600W	2x TLED52W	3.0	355 m3/h	178 m3/h	
L280	Lodge 280x120x210 cm	R2.60	27.0	240-40	120	75-75-60	-	250	1/1	250	1/1	75	2/1	2x HPS600W	3x TLED52W	6.0	725 m3/h	363 m3/h	
<b>HOBBY 'FLUO COMPACT' GROW TENTS</b>																			
REF	DESIGNATION	REV	Net kg	W cm	D cm	H cm	Web/T Elastic Web Thread	Extraction Ø (mm)	Intracation Ø (mm)	Cables Ø (mm)	CoolTubes Ø (mm)	Poles Max/Tent	StrapIT HookIT Cablett Pair #	Flowering CFL 2100°K	Grow Space CFL 6500°K	m3	Flow (every 1-2 min) Extraction Intake	Grow (every 2-4 min) Extraction Intake	
CR60	Cristal Room 60x60x55 cm	R2.60	1.2	60	60	55	-	Permissive	Permissive	75	1	3	15	1x CFL125W	1x CFL65W	0.1	Permissive	Permissive	
CR110	Cristal Room 110x110x105 cm	R2.60	3.4	110	110	105	-	150	1	150	1	10 kg	-	1x CFL300W	1x CFL200W	0.7	45 m3/h	20 m3/h	
CR145	Cristal Room 145x145x140 cm	R2.60	5.7	145	145	140	-	150	1	150	1	10 kg	-	1x CFL450W	1x CFL300W	1.7	105 m3/h	50 m3/h	
<b>PROPAGATION</b>																			
REF	DESIGNATION	REV	Net kg	W cm	D cm	H cm	Web/T Elastic Web Thread	Extraction Ø (mm)	Intracation Ø (mm)	Cables Ø (mm)	CoolTubes Ø (mm)	Poles Max/Pole	StrapIT HookIT Cablett Pair #	Flowering TELD 3000°K	Grow Space TLED 6500°K	m3	Flow (every 1-2 min) Extraction Intake	Grow (every 2-4 min) Extraction Intake	
DP60	Dark Propagator 60x40x60 cm	R2.60	2.8	60	40	60	-	150	1	150	1	2	10 kg	2x TLED26W	1x TLED26W	0.1	10 m3/h	5 m3/h	
DP90	Dark Propagator 90x60x90 cm	R2.60	4.5	90	60	90	-	150	1	150	1	2	10 kg	3x TLED26W	2x TLED26W	0.5	30 m3/h	15 m3/h	
DP120	Dark Propagator 120x60x120 cm	R2.60	12.8	120	60	3x40	-	200	1	200	1	10	5 kg	6x TLED52W	3x TLED52W	0.9	50 m3/h	25 m3/h	
<b>DRYER</b>																			
REF	DESIGNATION	REV	Net kg	W cm	D cm	H cm	Web/T Elastic Web Thread	Extraction Ø (mm)	Intracation Ø (mm)	Cables Ø (mm)	CoolTubes Ø (mm)	Poles Max/Pole	StrapIT HookIT Cablett Pair #	Flowering TELD 3000°K	Grow Space TLED 6500°K	m3	Flow (every 1-2 min) Extraction Intake	Grow (every 2-4 min) Extraction Intake	
DD90	Dark Dryer 90x90x185 cm	R2.60	6.0	90	90	185	-	Permissive	Permissive	200	1	75	1	15	-	-	1.5	90 m3/h	45 m3/h

**MAIN TECHNO R3.00**  
 Main Fabric: Mylar 190T  
 Poles Ø16 mm  
 Plastic Corners 3 mm thick  
 Water Tray: Mylar 190T  
 Space Booster Inc.  
 Web Plant Support Inc.  
 Bag Fabric: 210D

**MAIN TECHNO R2.60**  
 Main Fabric: Mylar 190T  
 Poles Ø16 mm  
 Plastic Corners 3 mm thick  
 Water Trays: Mylar 190T  
 Metal Grid  
 Water Tray: Mylar 190T

**MAIN TECHNO DP R2.60**  
 Main Fabric: Mylar 190T  
 Poles Ø16 mm  
 Plastic Corners 3 mm thick  
 Water Tray: Mylar 190T  
 Bag Fabric: 210D

**MAIN TECHNO DD R2.60**  
 Main Fabric: Sylver 210FPU  
 Poles Ø16 mm  
 Plastic Corners 3 mm thick  
 Bag Fabric: 210D

# IMPERIAL SYSTEM

HOBBY GROW TENTS	DESIGNATION	REV	WGHT	ASSEMBLED	WEBBING	EXTRACTION	SOCK CONFIG	COOL/TUBES	HANDLING	ACCESSORIES	LIGHTING ADVISED	VOL	EXTRACTION ADVISED	
REF			Net lb	W in	D in	H in	Extraction Ø (in) # / #	Cables Ø (in) #	Poles #	StrapIT Pair #	HookIT Pair #	CabieIT Pair #	HPS Extraction Intake	LED Extraction Intake
D560	Dark Street 2' x 2' x 5'	R3.00	11.9	35.5	23.5	59.0	6 1 6 1 3 1	3 1	2 20 lb	1 1	15	15	38 cfm	19 cfm
DS90	Dark Street 3' x 3' x 5 1/2'	R3.00	16.5	35.5	35.5	67.0	6 1 6 1 3 1	3 1	2 20 lb	1 1	15	15	98 cfm	49 cfm
DS120	Dark Street 4' x 4' x 6'	R3.00	25.4	47.0	73.0	78.5	8 1 8 1 3 1	3 1	2 20 lb	1 1	15	15	186 cfm	93 cfm
DS150	Dark Street 5' x 5' x 6 1/2'	R3.00	30.4	59.0	78.5		8 1 8 1 3 1	3 1	2 20 lb	1 1	15	15	316 cfm	158 cfm
DS120W	Dark Street 4' x 2' x 5 1/2'	R3.00	17.9	47.0	23.5	67.0	6 1 6 1 3 1	3 1	2 20 lb	1 1	15	15	85 cfm	43 cfm
DS240W	Dark Street 8' x 4' x 6 1/2'	R3.00	37.5	94.5	47.0	78.5	10 1 10 1 3 1	3 1	2 20 lb	1 2	30	30	403 cfm	201 cfm
V100	Vintage 3 1/2' x 3 1/2' x 6 1/2'	R3.00	22.0	40.5	40.5	78.5	8 1 8 2 3 2	2 8	2 20 lb	1 1	15	15	149 cfm	74 cfm
HOBBY "2 ROOMS" GROW TENTS														
REF	DESIGNATION	REV	Net lb	W in	D in	H in	Extraction Ø (in) # / #	Cables Ø (in) #	Poles #	StrapIT Pair #	HookIT Pair #	CabieIT Pair #	HPS Extraction Intake	LED Extraction Intake
T60	Twin 2' x 2' x 6 1/4'	R2.60	18.5	24	24	59-16	6 1/1 6 1/1 3 1/1	3 1/1	4 20 lb	1 2	15	15	39 cfm	20 cfm
T90	Twin 3' x 3' x 7 1/4'	R2.60	29.1	36	36	63-24	8 1/1 8 1/1 3 1/1	3 1/1	4 20 lb	1 2	15	15	94 cfm	47 cfm
HOBBY "3 ROOMS" GROW TENTS														
REF	DESIGNATION	REV	Net lb	W in	D in	H in	Extraction Ø (in) # / #	Cables Ø (in) #	Poles #	StrapIT Pair #	HookIT Pair #	CabieIT Pair #	HPS Extraction Intake	LED Extraction Intake
L90	Lodge 3' x 2' x 4 1/2'	R2.60	20.7	24-12	24	29-24	6 1/1 6 1/1 3 1/1	3 1/1	4 20 lb	2 3	15	15	35 cfm	18 cfm
L120	Lodge 4' x 3' x 4 1/2'	R2.60	28.7	36-12	36	33-33	8 1/1 8 1/1 3 1/1	3 1/1	4 20 lb	2 3	15	15	85 cfm	43 cfm
L160	Lodge 5 1/2' x 4' x 6 1/2'	R2.60	37.0	48-16	48	47-34	8 1/1 8 1/1 3 1/1	3 1/1	4 20 lb	2 3	15	15	108 cfm	108 cfm
L280	Lodge 9 1/2' x 4' x 7'	R2.60	59.5	95-16	48	30-30-23	10 1/1 10 1/1 3 1/1	3 1/1	6 20 lb	2 4	30	30	437 cfm	219 cfm
HOBBY "FLOU COMPACT" GROW TENTS														
REF	DESIGNATION	REV	Net lb	W in	D in	H in	Extraction Ø (in) # / #	Cables Ø (in) #	Poles #	StrapIT Pair #	HookIT Pair #	CabieIT Pair #	Flow Extraction Intake	Grow Extraction Intake
CR60	Cristal Room 2' x 2' x 2'	R2.60	2.6	23.5	23.5	21.5	Permissive	3 1	-	-	-	-	Permissive	Permissive
CR110	Cristal Room 3 1/2' x 3 1/2' x 3 1/2'	R2.60	7.5	43.5	43.5	41.5	Permissive	3 1	-	-	-	-	26 cfm	13 cfm
CR145	Cristal Room 5' x 5' x 5'	R2.60	12.8	57.0	57.0	55.0	6 1	3 1	-	-	-	-	16 cfm	8 cfm
PROPAGATION														
REF	DESIGNATION	REV	Net lb	W in	D in	H in	Extraction Ø (in) # / #	Cables Ø (in) #	Poles #	StrapIT Pair #	HookIT Pair #	CabieIT Pair #	Flow Extraction Intake	Grow Extraction Intake
DP60	Dark Propagator 2' x 1 1/2' x 2'	R2.60	6.2	23.5	15.5	23.5	6 1	3 1	2 20 lb	1 1	15	15	5 cfm	2 cfm
DP90	Dark Propagator 3' x 2' x 3'	R2.60	9.9	35.5	23.5	35.5	Windows	3 1	2 20 lb	1 1	15	15	17 cfm	9 cfm
DP120	Dark Propagator 4' x 2' x 4'	R2.60	28.2	47.0	23.5	3x16	Permissive	3 1	10 10 lb	1 6	30	30	45 cfm	22 cfm
DRYER														
REF	DESIGNATION	REV	Net lb	W in	D in	H in	Extraction Ø (in) # / #	Cables Ø (in) #	Poles #	StrapIT Pair #	HookIT Pair #	CabieIT Pair #	Flow Extraction Intake	Grow Extraction Intake
DD90	Dark Dryer 3' x 3' x 6'	R2.60	13.2	35.5	35.5	73.0	Permissive	8 1	2 20 lb	1 1	15	15	53 cfm	27 cfm

**MAIN TECHNO R3.00**  
Main Fabric: Mylar 190T  
Poles Ø0.63"  
Plastic Corners 0.12" thick  
Water Tray: Mylar 190T  
Space Booster Inc.  
Web Plant Support Inc.  
Bag Fabric: 210D

**MAIN TECHNO R2.60**  
Main Fabric: Mylar 190T  
Poles Ø0.63"  
Plastic Corners 0.12" thick  
Water Trays: Mylar 190T  
Metal Grid  
Water Tray: Mylar 190T

**MAIN TECHNO DP R2.60**  
Main Fabric: Mylar 190T  
Poles Ø0.63"  
Plastic Corners 0.12" thick  
Water Tray: Mylar 190T  
Bag Fabric: 210D

**MAIN TECHNO DD R2.60**  
Main Fabric: Silver 210PU  
Poles Ø0.63"  
Plastic Corners 0.12" thick  
Bag Fabric: 210D

REF	DESIGNATION	DESIGNATION	DS60	DS90	DS120	DS150	DS120w	DS240W	V100	T60	T90	L90	L120	L160	L280	DP60	DP90	DP120	DP120
T16-A	Pole Ø16 mm 563 mm long	Pole Ø0.63" 22" long	14				7			15	4	20	6		8	9	5	18	
T16-B	Pole Ø16 mm 730 mm long	Pole Ø0.63" 29" long	8							8	4	6			16				
T16-C	Pole Ø16 mm 835 mm long	Pole Ø0.63" 33" long		22	4	28					22		20	6			9		14
T16-D	Pole Ø16 mm 980 mm long	Pole Ø0.63" 39" long			4	8			23										4
T16-E	Pole Ø16 mm 1162 mm long	Pole Ø0.63" 46" long			14	8													8
T16-F	Pole Ø16 mm 373 mm long	Pole Ø0.63" 15" long								4									12
T16-G	Pole Ø16 mm 275 mm long	Pole Ø0.63" 11" long																	
T16-Y	Corner Ø16 mm 3 axes Y shape	Corner Ø0.63" 3 axes Y shape	8	8	8	8	8	8	8	8	8	8	8	8	8	8	8	8	8
T16-K	Corner Ø16 mm 4 axes K shape	Corner Ø0.63" 4 axes K shape								4	4	4	4	4	4	4	4	4	4
T16-L	Link Ø16 mm Straight Joint	Link Ø0.63" Straight Joint	4	4	4	18	4	6	4	4	4	2	2	2	2	2	2	2	2
T16-LL	Link Ø16 mm Straight Joint L	Link Ø0.63" Straight Joint L																	
T16-H	Handling Ø16 mm 1 axe I shape	Handling Ø0.63" 1 axe I shape	4	4	4	4	4	4	6	6	12	8	8	12	20	4	4	20	4
T16-SB	Space Booster Ø16 mm 2 axes Y Shape	Space Booster Ø0.63" 2 axes Y Shape	4	4	4	4	4	6	4	4									
GS60.30	Grid Shelve 60x30 cm	Grid Shelve 24" x 12"	4	4	4	4	4	4	4	2									8
GS90.30	Grid Shelve 90x30 cm	Grid Shelve 36" x 12"									3								





# LODGE

HOBBY



[www.secretjardin.com](http://www.secretjardin.com)



[www.secretjardin.com](http://www.secretjardin.com) - [info@secretjardin.com](mailto:info@secretjardin.com)

Q3 - 2016